

# SAFETY-TITE HAMMERLESS

## Tooth Fastening System for Excavators & Loaders

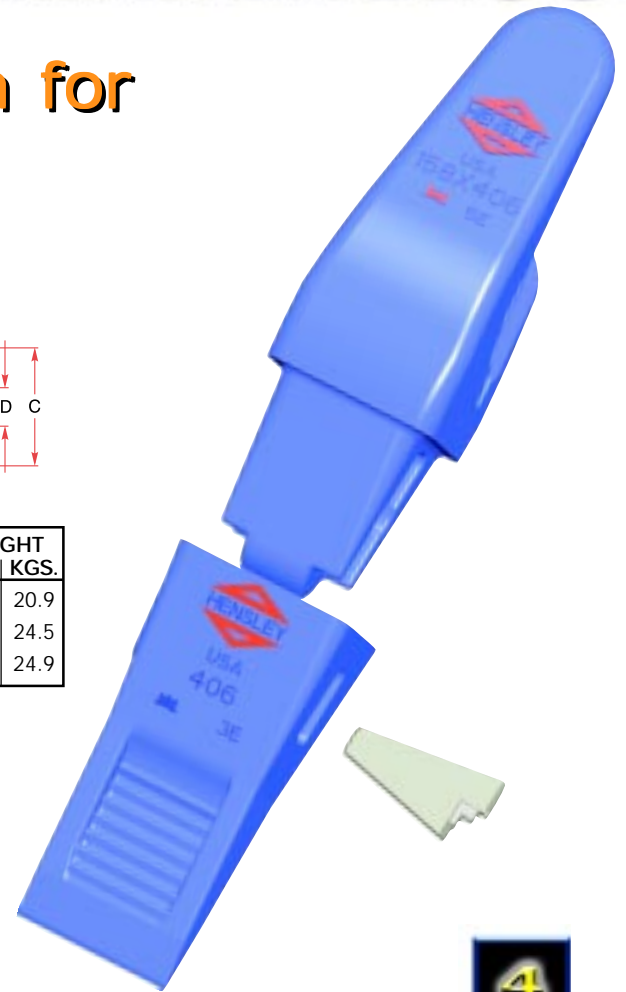
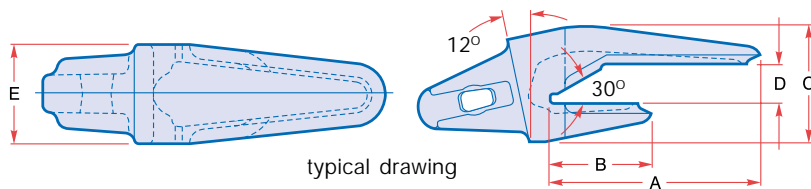

PART NO.	DIMENSIONS - inches (mm)					WEIGHT	
	A	B	C	D	E	LBS.	KGS.
937X406	10-7/8"(276)	5-1/4"(133)	5-7/8"(149)	1-13/16"(46)	5-1/8"(130)	46.0	20.9
158X406	10-3/4"(273)	5-1/4"(133)	6-1/8"(156)	1-9/16"(40)	5-1/8"(130)	54.0	24.5
940X406	10-7/8"(276)	5-1/4"(133)	6"(152)	2-1/16"(52)	5-1/8"(130)	55.0	24.9

<p><b>406</b> 21.8 lbs. (9.9 kgs.)</p>	<p><b>406RP2</b> 34.0 lbs. (15.4 kgs.)</p>
<p><b>406RC</b> 30.0 lbs. (13.6 kgs.)</p>	<p><b>Pocket Detail</b></p>

**406 SERIES**



**Safer • No Hammer Needed • Quicker Change-Outs**



# SAFETY-TITE HAMMERLESS

## 406 DYNA-WEDGE

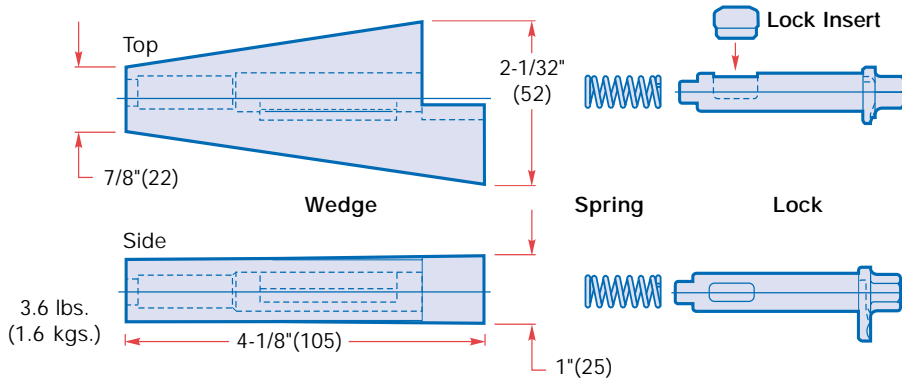

### A406P2 Dyna-Wedge

(Sold as an assembly only)

- Assembly Includes:
- 406/506P (wedge)
  - 406PS (spring)
  - 406PL (lock)
  - 406PR (lock insert)

### DYNA-WEDGE, new

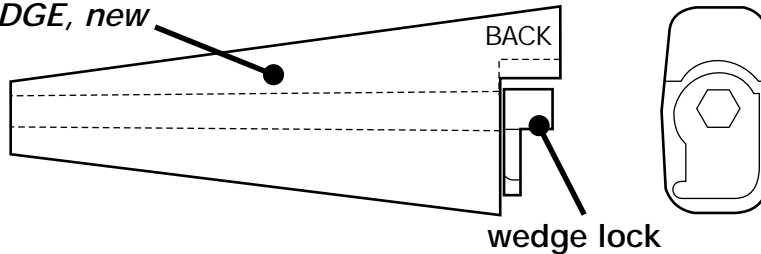

The  
DYNA-WEDGE  
is reusable!

The **DYNA-WEDGE** comes assembled and ready to use. Notice that the wedge lock is inserted into the **DYNA-WEDGE** as far as it will go.

### DYNA-WEDGE, used

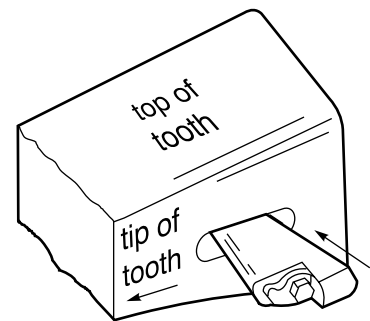
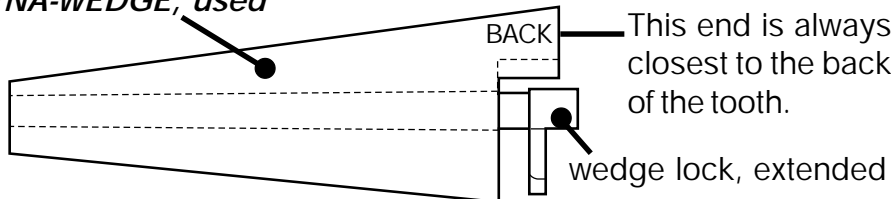

On a used **DYNA-WEDGE**, the wedge lock will extend out from the body of the wedge. The wedge lock will need to be tapped back into its original position to allow for ease of use on the next installation.

### Hensley Industries, Inc.

2108 Joe Field Road  
Dallas, TX 75229  
www.hensleyind.com

Customer Service:

Toll Free U.S./Canada      All Other Locations  
Phone: (888) 406 - 6262      Phone: (972) 406 - 6262  
Fax: (888) 241 - 3274      Fax: (972) 241 - 3274



Your Authorized  
Hensley Dealer

P/406 hammerless 9-00

**Safety First:** Hensley recommends that you use a soft-faced hammer and ANSI-approved (Z87.1) eye protection while using our products.