



HAMMERLESS FASTENING SYSTEM FOR WHISLER ADAPTERS

System Features:

- **Safer and easier - no hammer needed for installation or removal.**
- **Eliminates need to work under dipper to remove lock.**
- **Quicker adapter change-out.**
- **No lip modification necessary. Fits existing Whisler lips and standard adapters.**
- **Available for WH-12 and WH-10 adapters. WH-8 coming soon.**



INSTALLATION:

The hammerless fastener system is easy to install. Few tools other than a 3/4" socket and a torque wrench are required. As always, follow proper mine safety procedures and wear all required safety equipment.

Use 3/4" socket to tighten adjustment bolt ensuring contact is maintained in the indicated areas. Do not over tighten adjustment bolt.

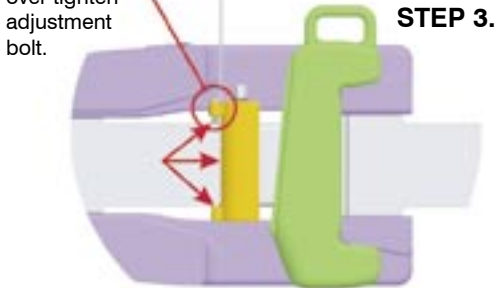

Tighten shim adjustment bolt to ensure shim fully contacts lip in indicated areas. Do not overtighten adjustment bolt.

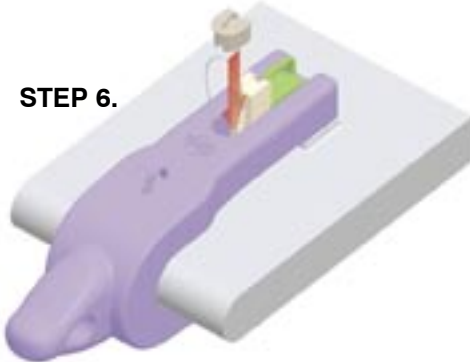

Install plug aligning the radius of the plug with the radius of the adapter and firmly secure in place.

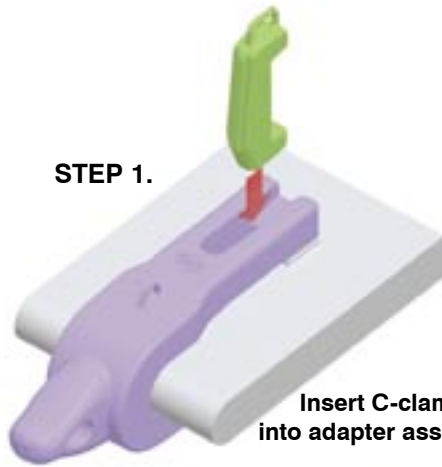

STEP 1.

Insert C-clamp into adapter assembly.

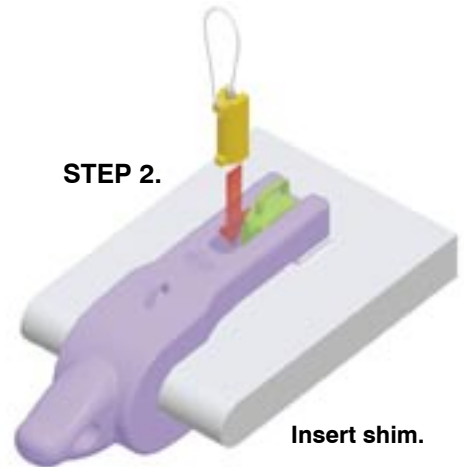

STEP 2.

Insert shim.

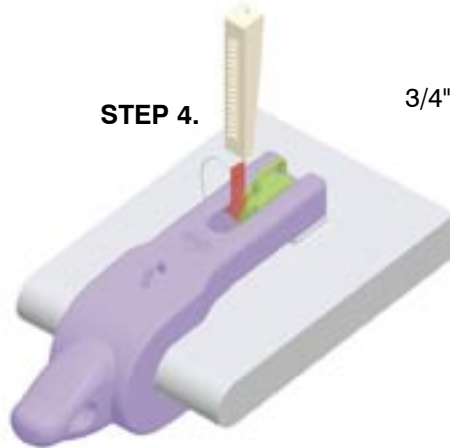

STEP 4.

Insert wedge.

STEP 5.
3/4" hex drive shaft

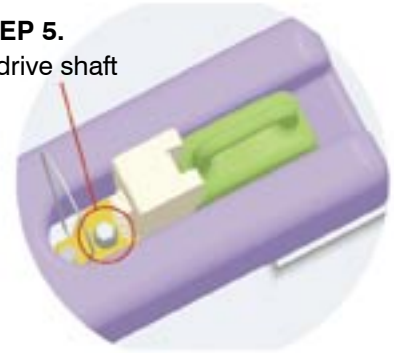

Secure the wedge until it is fully seated by turning the drive shaft (3/4") within the shim clockwise. Apply approximately 400 ft. lbs..

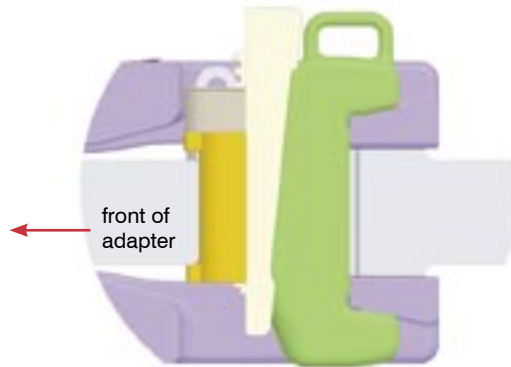

Cross-section of complete assembly.

SYSTEM PARTS	
Whisler 10	
C-CLAMP	H499C
SHIM	H499SHIM
WEDGE	H499W
PLUG	H1P
Whisler 12	
C-CLAMP	H599C
SHIM	H599SHIM
WEDGE	H5992
PLUG	H1P

YOUR AUTHORIZED HENSLEY DEALER



Hensley Industries, Inc.
 2108 Joe Field Road
 Dallas, Texas 75229 U.S.A
 (888) 406 - 6262 U.S./Canada
 (972) 406 - 6262 all other locations
www.hensleyind.com



Copyright © 2007 Hensley Industries, Inc.