



Specification Guide

Mining Teeth & Adapters

XS85 - XS342 Series

TS922 - TS1222 Series

XSC12 & XSC127

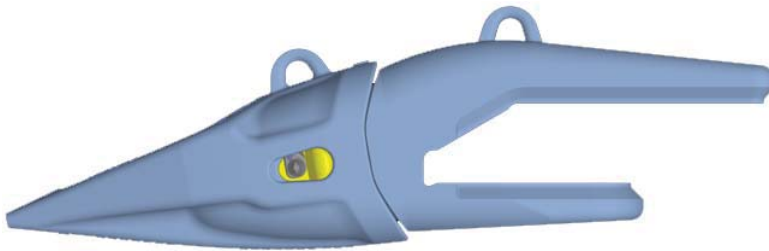

March 2011



Fastener Styles

Standard/Heavy

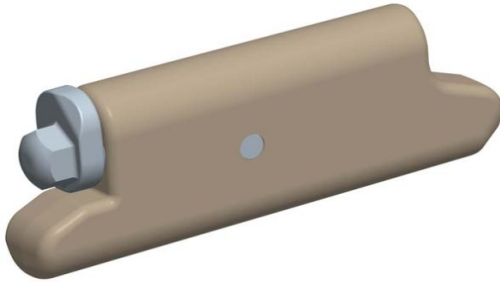

Installation Instructions

1. With tooth on nose, install pin with locking tab in the unlock position
2. Using a socket wrench rotate the locking tab clockwise 90° to lock

Slag

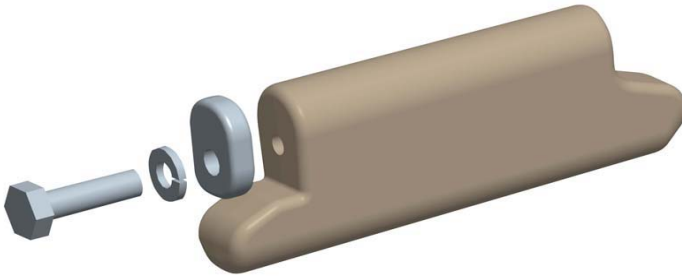

Installation Instructions

1. With tooth on nose, install entire pin with locking tab in the unlock position
2. Manually rotate the locking tab with a screw driver from unlock to lock position
3. Tighten bolt thoroughly into the body of the pin

Recommended Pin torque (ft-lbs)

Series	Torque (ft-lbs)
XS85	30
XS115	50
XS145/152	50
XS250/252	50
XS340/342	50



85 Series Specifications

Teeth & Fasteners

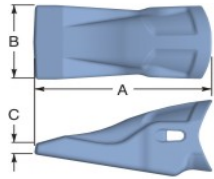

AG
High Abrasion

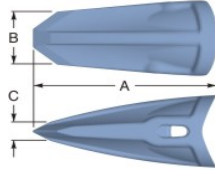

RC
Rock Chisel

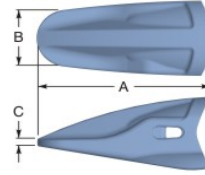

RP1/RP2
Rock Penetrator

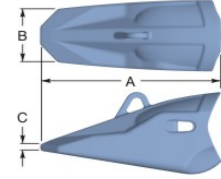

RPX
Rock Penetrator

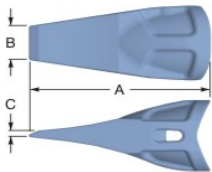

SD
Chisel

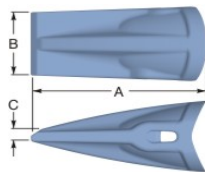

SYL
Sharp, Ribbed

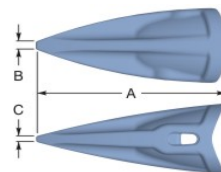

T
Tiger

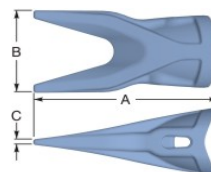

UT
Twin Tiger

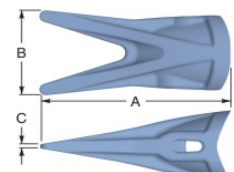

WT
Twin Tiger

TEETH																
XS Series	Part Number	Pin Assembly	Dimensions											Weight		
			Overall Tooth						Tooth Pocket							
			A		B		C		D		E		F			
			"	mm	"	mm	"	mm	"	mm	"	mm	"	mm	lb	kg
85	XS85AG	XS85PX	16.7	424	7.6	193	1.9	48	7.5	190	5.4	138	5.7	144	97.0	44.0
	XS85HS		Under Development													
	XS85RC		16.6	422	5.3	135	1.9	48	7.5	190	5.4	138	5.7	144	55.0	24.9
	XS85RP2		17.1	434	6.0	152	0.8	19	7.5	190	5.4	138	5.7	144	93.0	42.2
	XS85RP3		17.1	434	6.0	152	0.8	20	7.5	190	5.4	138	5.7	144	104.0	47.2
	XS85RPX		17.2	436	5.6	142	2.5	64	7.5	190	5.4	138	5.7	144	111.0	50.3
	XS85SD		Under Development													
	XS85SYL		15.9	404	6.4	162	0.9	24	7.5	190	5.4	138	5.7	144	53.5	24.3
	XS85T		17.4	441	0.8	20	0.6	14	7.5	190	5.4	138	5.7	144	47.0	21.3
	XS85UT		17.4	441	8.5	215	0.6	14	7.5	190	5.4	138	5.7	144	55.0	24.9
XS85WT	17.4	442	8.5	215	0.4	11	7.5	190	5.4	138	5.7	144	48.3	21.9		

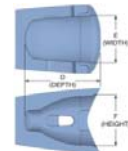
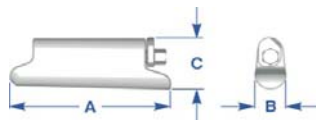

Tooth Pocket

FASTENERS											
Duty Rating	Part Number	Dimensions						Weight		Socket	
		A		B		C					
		"	mm	"	mm	"	mm	lb	kg	"	mm
Heavy Duty	XS85PX	7.0	178	1.2	31	2.6	65	3.8	1.7	9/16	14
Standard	XS85PC	7.0	178	1.2	31	2.6	65	3.8	1.7	9/16	14
Slag*	XS85PS	7.0	178	1.2	31	2.6	65	3.8	1.7	9/17	15

* Slag pin is NOT reusable



85 Series Specifications

Weld-on Adapters

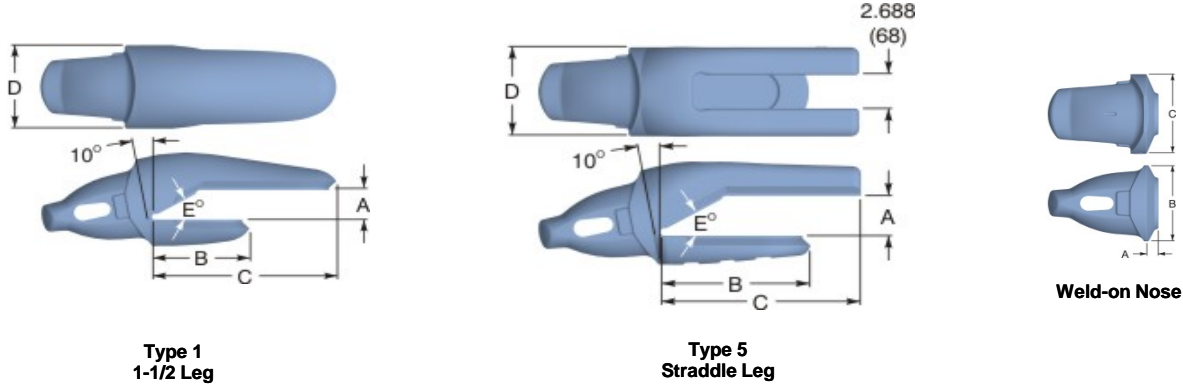

ADAPTERS		Dimensions														Weight	
XS Series	Part Number	Type	A		B		C		D		E	Spade Angle	Lip Thickness		Weight		
			"	mm	"	mm	"	mm	"	mm			Bevel	"			mm
85	1080MXS85	1	3.2	82	7.5	190	14.2	361	6.8	173	30°	-	3.0	80	99.0	44.9	
	1080MXS85L	1	3.2	82	8.0	203	14.5	368	6.8	173	30°	12°	3.0	80	99.0	44.9	
	1080MXS85R	1	3.2	82	8.0	203	14.5	368	6.8	173	30°	12°	3.0	80	99.0	44.9	
	1090MXS85	1	3.6	92	7.3	186	14.1	357	6.8	173	30°	-	3.5	90	99.0	44.9	
	1250XS85	1	2.6	66	7.5	190	14.3	364	6.8	173	30°	-	2.5	63	98.0	44.5	
	1275XS85	1	2.8	72	7.5	190	14.4	365	6.8	173	30°	-	2.75	70	94.0	42.6	
	1275XS85L	1	2.8	72	7.4	188	14.2	359	6.8	173	30°	12°	2.75	70	103.0	46.7	
	1275XS85R	1	2.8	72	7.4	188	14.2	359	6.8	173	30°	12°	2.75	70	103.0	46.7	
	1300XS85	1	3.1	78	7.5	190	14.3	362	6.8	173	30°	-	3.0	76	97.0	44.0	
	1300XS85L	1	3.1	78	7.4	188	14.2	359	6.8	173	30°	12°	3.0	76	108.0	49.0	
	1300XS85R	1	3.1	78	7.4	188	14.2	359	6.8	173	30°	12°	3.0	76	108.0	49.0	
	1303XS85CC	1	3.0	76	11.5	292	14.2	360	7.0	178	30°	10°	3.0	76	215.5	97.8	
	1310XS85*	1	3.1	78	8.6	217	14.3	364	6.8	173	30°	-	3.0	76	98.2	44.5	
	1310XS85L*	1	3.1	78	8.6	217	14.3	364	6.8	173	30°	-	3.0	76	103.0	46.7	
	1310XS85R*	1	3.1	78	8.6	217	14.3	364	6.8	173	30°	-	3.0	76	103.0	46.7	
	1310XS85SL	5	3.1	78	8.6	217	14.3	364	6.8	173	30°	-	3.0	76	103.0	46.7	
	1350XS85	1	3.6	91	7.4	189	14.2	360	6.8	173	30°	-	3.5	89	93.0	42.2	
	1350XS85L	1	3.6	91	7.4	187	14.2	359	6.8	173	30°	12°	3.5	89	95.0	43.1	
	1350XS85R	1	3.6	91	7.4	187	14.2	359	6.8	173	30°	12°	3.5	89	95.0	43.1	
	XS85WN	Weld-on Nose	0.9	23	6.5	165	6.7	171							43.0	19.5	
	U85HX	Wear Cap													5.8	2.6	
	WC85HX	Wear Cap													10.7	4.9	

* = Available as assembly with wear cap



SAFETY FIRST: Hensley Industries, Inc. recommends that you use a soft-faced hammer and ANSI-approved (Z87.1) eye protection while using our products.
Copyright © 2011 Hensley Industries, Inc.

This publication is protected under the copyright laws of the United States. Unauthorized duplication or distribution is prohibited.



115 Series Specifications

Teeth & Fasteners

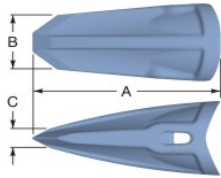

RC
Rock Chisel

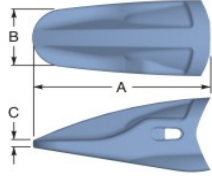

RP2
Rock Penetrator

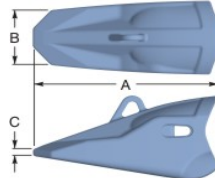

RPX
Rock Penetrator

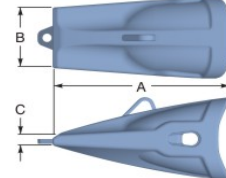

SC
Short Chisel

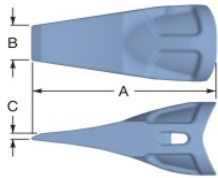

SD
Chisel

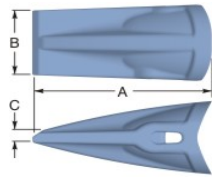

SYL
Sharp, Ribbed

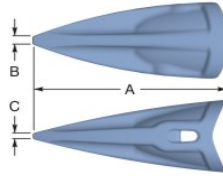

T
Tiger

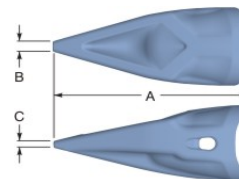

TV
Tiger

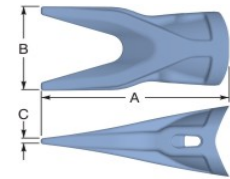

UT
Twin Tiger

TEETH		Pin Assembly	Dimensions												Weight	
XS Series	Part Number		Overall Tooth						Tooth Pocket							
			A		B		C		D		E		F			
			"	mm	"	mm	"	mm	"	mm	"	mm	"	mm	lb	kg
115	XS115RC	XS115PX	18.3	464	6.0	152	2.0	51	8.5	215	6.0	153	6.3	161	82.0	37.2
	XS115RP2		18.7	476	5.5	140	2.2	55	8.5	215	6.0	153	6.3	161	128.5	58.3
	XS115RPX		19.3	491	6.3	160	0.8	22	8.5	215	6.0	153	6.3	161	152.5	69.2
	XS115SC		Under Development													
	XS115SD		17.9	454	4.5	114	2.3	57	8.5	215	6.0	153	6.3	161	80.0	36.3
	XS115SYL		17.9	454	7.2	182	1.2	30	8.5	215	6.0	153	6.3	161	78.0	35.4
	XS115T		19.1	485	1.1	28	0.8	20	8.5	215	6.0	153	6.3	161	76.0	34.5
	XS115TV		Under Development													
XS115UT	19.1	485	9.6	243	0.8	20	8.5	215	6.0	153	6.3	161	78.0	35.4		

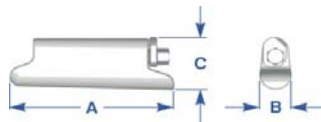

Tooth Pocket

FASTENERS		Part Number	Dimensions						Weight		Socket	
Duty Rating	Pin Assembly		A		B		C					
			"	mm	"	mm	"	mm	lb	kg	"	mm
Heavy Duty	XS115PX	8.0	203	1.5	39	2.7	69	5.5	2.5	5/8	16	
Standard	XS115PC	8.0	203	1.5	39	2.7	69	5.5	2.5	5/8	16	
Slag*	XS115PS	8.0	203	1.5	39	2.7	69	5.5	2.5	5/8	16	

* Slag pin is NOT reusable



115 Series Specifications

Weld-on Adapters

Type 1
1-1/2 Leg

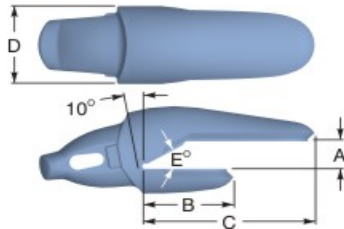

Type 5
Straddle Leg

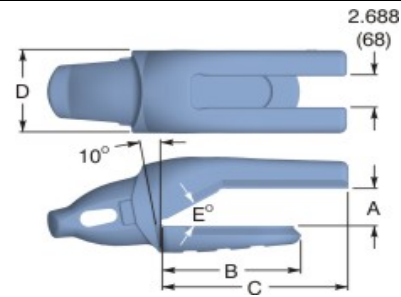

Type 6
T Corner

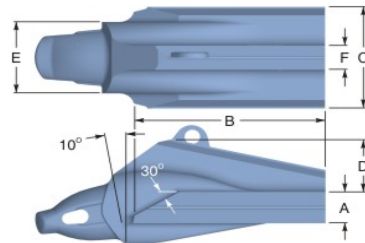

Type 14
Raised Top Leg

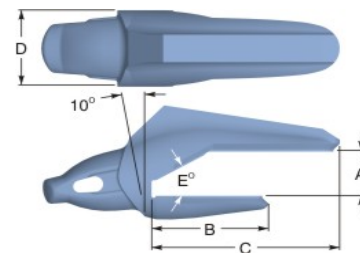

ADAPTERS

XS Series	Part Number	Type	Dimensions											Weight		
			A		B		C		D		E	Spade Angle	Lip Thickness			
			"	mm	"	mm	"	mm	"	mm	Bevel		"	mm	lb	kg
115	1070MXS115	1	2.9	72	-	-	16.1	409	7.7	195	30°	-	2.8	70	146.0	66.2
	1090MXS115*	1	3.6	92	11.8	301	15.9	406	7.6	195	30°	-	3.5	90	137.0	62.1
	1090MXS115L*	1	3.6	92	11.8	301	15.9	406	7.6	195	30°	15°	3.5	90	144.0	65.3
	1090MXS115R*	1	3.6	92	11.8	301	15.9	406	7.6	195	30°	15°	3.5	90	144.0	65.3
	300XS115*	1	3.1	79	12.0	304	16.2	412	7.7	195	30°	-	3.0	76	143.0	64.9
	301XS115*	1	3.1	79	11.9	301	16.1	409	7.7	195	30°	10°	3.0	76	154.0	69.9
	302XS115*	1	3.1	79	11.9	301	16.1	409	7.7	195	30°	10°	3.0	76	153.0	69.4
	350XS115	1	3.6	91	8.5	216	16.1	409	7.7	195	30°	-	3.5	89	128.0	58.1
	350XS115C	14	3.6	91	8.5	216	17.4	442	7.7	195	30°	-	3.5	89	144.0	65.3
	351XS115	1	3.6	91	8.5	216	16.1	409	7.7	195	30°	12°	3.5	89	138.0	62.6
	352XS115	1	3.6	91	8.5	216	16.1	409	7.7	195	30°	12°	3.5	89	138.0	62.6
	356XS115SL	5	3.6	91	10.0	254	17.5	444	7.7	195	30°	-	3.5	89	170.0	77.1
	516XS115**	1	Under Development													
	90XS115CC	6	3.5	89	21.3	541	11.5	292	6.1	155	-	-	3.5	89	374.0	169.6
	XS115WN	Weld-on Nose	9.8	249	7.3	185	7.7	195							62.5	28.3
	WC115HX	Wear Cap													11.7	5.3

* = Available as assembly with wear cap

** = 16° nose angle





145 Series Specifications

Teeth & Fasteners

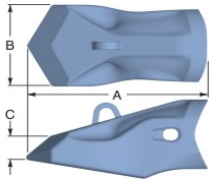

HAT
Rock Penetrator

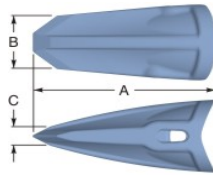

RC
Rock Chisel

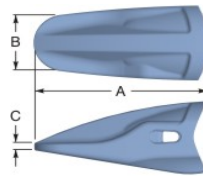

RP2/3
Rock Penetrator

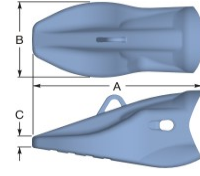

RPHL
Rock Penetrator

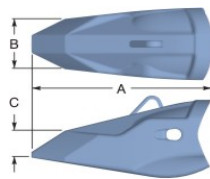

RPL
Rock Penetrator

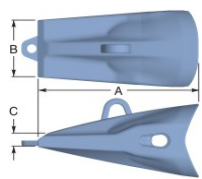

SC
Short Chisel

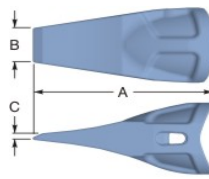

SD
Chisel

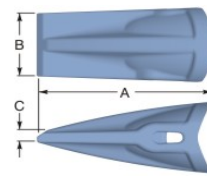

SYL
Sharp, Ribbed

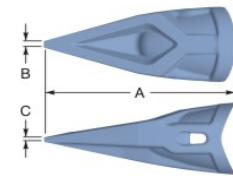

TV
Tiger

TEETH		Pin Assembly	Dimensions											Weight		
XS Series	Part Number		Overall Tooth						Tooth Pocket							
			A		B		C		D		E		F			
			"	mm	"	mm	"	mm	"	mm	"	mm	"	mm	lb	kg
145	XS145HAT	XS145PX	Under Development													
	XS145RC		20.9	530	6.6	168	2.4	61	9.5	240	6.7	171	7.2	181	117.0	53.1
	XS145RP2		21.5	546	7.7	195	1.5	38	9.5	240	6.7	171	7.2	181	188.0	85.3
	XS145RP3		21.5	546	7.5	189	1.0	25	9.5	240	6.7	171	7.2	181	205.0	93.0
	XS145RPHL		21.5	546	10.5	266	1.5	38	9.5	240	6.7	171	7.2	181	225.0	102.1
	XS145RPL		21.5	545	6.5	165	0.7	18	9.5	240	6.7	171	7.2	181	204.0	92.5
	XS145SC		18.1	459	7.0	178	1.7	43	9.5	240	6.7	171	7.2	181	105.0	47.6
	XS145SD		19.9	506	5.0	127	2.5	63	9.5	240	6.7	171	7.2	181	108.0	49.0
	XS145SYL		20.0	508	8.0	203	1.5	38	9.5	240	6.7	171	7.2	181	113.0	51.3
XS145TV	21.3	539	1.3	32	0.8	21	9.5	240	6.7	171	7.2	181	105.0	47.6		

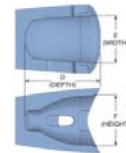
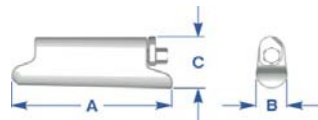

Tooth Pocket

FASTENERS		Part Number	Dimensions					Weight		Socket	
Duty Rating	A		B		C	lb	kg	"	mm		
	"		mm	"	mm					"	mm
Heavy Duty	XS145PX	8.9	226	1.7	44	3.1	79	7.2	3.3	5/8	16
Standard	XS145PC	8.9	226	1.7	44	3.1	79	7.2	3.3	5/8	16
Slag*	XS145PS	8.9	226	1.7	44	3.1	79	7.2	3.3	5/8	16

* Slag pin is NOT reusable



145 Series Specifications

Weld-on Adapters

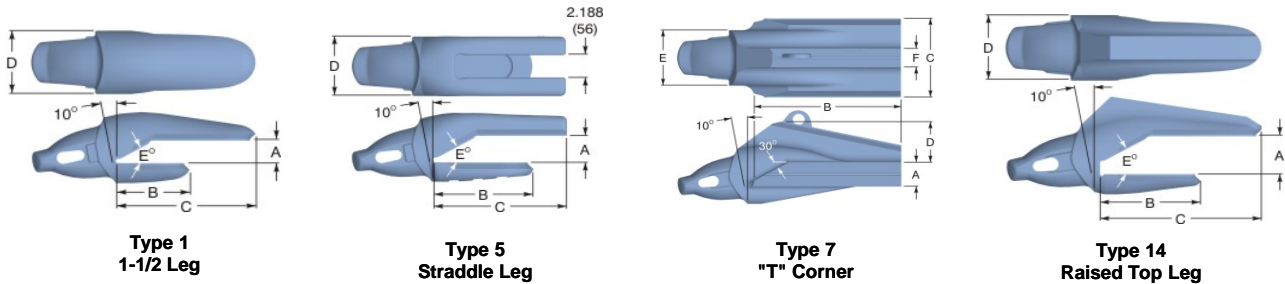

ADAPTERS		Type	Dimensions											Weight			
XS Series	Part Number		A	B	C	D	E	Spade Angle	Lip Thickness		lb	kg					
									"	mm			"	mm	"	mm	Bevel
145	120XS145CC*	7	4.8	121	21.5	546	13.1	332	8.8	222	30°	-	3.0	76	581.0	263.5	
	134XS145	Mechanical	4.2	107	9.2	234	15.0	381	10.5	266	0		4.0	102	530.0	240.4	
	136XS145	Mechanical	4.2	107	19.4	492	19.4	492	8.5	216	0		4.0	102	540.0	244.9	
	397XS145	Mechanical	4.2	107	19.5	495	19.5	495	8.5	216	0		4.0	102	385.0	174.6	
	400XS145	14	4.2	105	13.3	336	17.3	438	8.5	217	30°	-	4.0	102	275.0	124.7	
	400XS145***	1	4.1	104	13.7	348	17.7	449	9.0	228	30°	-	4.0	102	233.0	105.7	
	400XS145L***	1	4.2	107	13.7	348	17.7	449	9.0	228	30°	-	4.0	102	238.0	108.0	
	400XS145R***	1	4.2	107	13.7	348	17.7	449	9.0	228	30°	-	4.0	102	238.0	108.0	
	443XS145*	1	4.9	123	13.3	336	17.3	438	8.5	216	30°	-	4.75	121	215.0	97.5	
	447XS145	1	4.9	123	13.3	336	17.2	437	8.5	216	30°	-	4.75	121	235.0	106.6	
	A453XS145*	Mechanical		0	9.2	234	17.3	439	8.3	211	30°	-	4.75	121	388.0	176.0	
	A454XS145*	Mechanical		4.2	107	24.4	619	24.4	619	8.3	211	30°	-	4.75	121	420.0	190.5
	5R3XS145**											-	4.0	102	395.0	179.2	
	893XS145*	5	4.2	106	13.3	336	17.3	438	8.9	225	30°	-	4.0	102	227.0	103.0	
	893XS145CA		4.2	106	13.3	336	17.3	438	8.9	225	30°	-	4.0	102	280.0	127.0	
	894XS145*	1	4.2	106	13.3	336	17.3	438	8.5	217	30°	-	4.0	102	205.0	93.0	
	895XS145*	1	4.2	106	13.3	336	17.3	438	8.5	217	30°	-	4.0	102	205.0	93.0	
	896XS145*	1	4.2	106	13.3	336	17.3	438	8.9	225	30°	-	4.0	102	205.0	93.0	
	899XS145SL***	5	4.1	104	1.3	33	13.2	335	8.5	216	30°	-	4.0	102	242.0	109.8	
	XS145WN	Weld-on Nose		10.9	277	8.0	203	8.5	216							83.0	37.6
	WC145HX†	Wear Cap														29.0	13.2
U145HX	Wear Cap														37.0	16.8	
893WC145††	Wear Cap														18.5	8.4	
WC397HX†††	Wear Cap														24.0	10.9	

* = Available as assembly with wear cap

** = J-bolt adapter for Saber lip system

*** = Available with Laminite welded on

† = used with 443, 896, 894 & 895XS145 adapters

†† = used with 893XS145 & 893XS145CA adapter

††† = used with 397XS145 adapter

Weld-on Nose



SAFETY FIRST: Hensley Industries, Inc. recommends that you use a soft-faced hammer and ANSI-approved (Z87.1) eye protection while using our products.

Copyright © 2011 Hensley Industries, Inc.

This publication is protected under the copyright laws of the United States. Unauthorized duplication or distribution is prohibited.



152 Series Specifications

Teeth & Fasteners

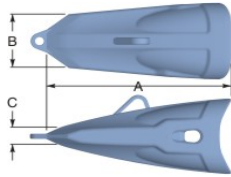

RC
Rock Chisel

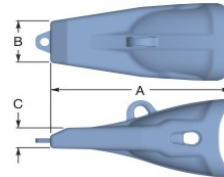

SD
Chisel

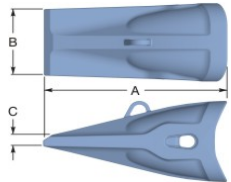

SYL
Sharp, Ribbed

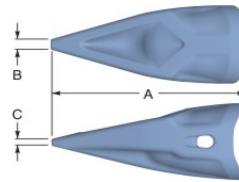

TV
Tiger

TEETH		Pin Assembly	Dimensions												Weight	
XS Series	Part Number		Overall Tooth						Tooth Pocket							
			A		B		C		D		E		F			
			"	mm	"	mm	"	mm	"	mm	"	mm	"	mm	lb	kg
152	XS152RC	XS145PX	21.2	538	6.6	169	2.4	60	-	-	-	-	-	-	142.0	64.4
	XS152RP2		Under Development													
	XS152RP3		Under Development													
	XS152RPL		Under Development													
	XS152RPHL		Under Development													
	XS152SC		Under Development													
	XS152SD		Under Development													
	XS152SYL		Under Development													
XS152TV	Under Development															

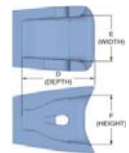
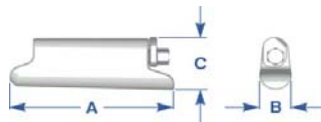

Tooth Pocket

FASTENERS		Part Number	Dimensions						Weight		Socket	
Duty Rating	Pin Assembly		A		B		C		lb	kg	"	mm
			"	mm	"	mm	"	mm				
Standard	XS145PC	8.9	226	1.7	44	3.1	79	7.2	3.3	5/8	16	
Heavy Duty	XS145PX	8.9	226	1.7	44	3.1	79	7.2	3.3	5/8	16	
Slag*	XS145PS	8.9	226	1.7	44	3.1	79	7.2	3.3	5/8	16	

* Slag pin is NOT reusable



152 Series Specifications

Weld-on Adapters

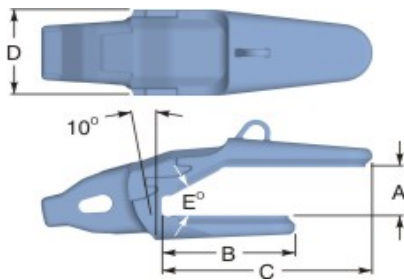

Type 1
1-1/2 Leg

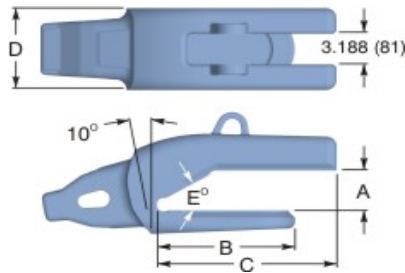

Type 5
Straddle Leg

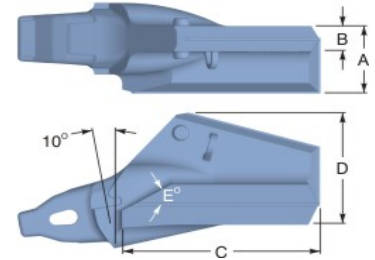

Type 8
"L" Corner

ADAPTERS

XS Series	Part Number	Type	Dimensions											Weight		
			A		B		C		D		E	Spade Angle	Lip Thickness			
			"	mm	"	mm	"	mm	"	mm	Bevel		"	mm	lb	kg
152	443XS152*	1	4.9	123	6.3	160	19.8	503	8.0	203	30°	-	4.75	121	233.0	105.7
	475XS152CL*	8	2.3	57	20.5	520	8.0	204	8.0	203	30°	-	4.75	121	493.0	223.6
	475XS152CR*	8	2.3	57	20.5	520	8.0	204	8.0	203	30°	-	4.75	121	493.0	223.6
	894XS152*	1	4.2	105	13.9	352	17.9	454	8.1	204	30°	15°	4.0	102	230.0	104.3
	895XS152*	1	4.2	105	13.9	352	17.9	454	8.1	204	30°	15°	4.0	102	230.0	104.3
	896XS152*	1	4.2	105	13.9	352	17.9	454	8.1	204	30°	-	4.0	102	230.0	104.3
	899XS152SL	5	4.2	105	13.9	352	17.9	454	8.9	226	30°	-	4.0	102	268.7	121.9
	WC152HX	Wear Cap														32.0

* = Available as assembly with wear cap

** = Lower vertical shroud used with 475XS152CR & CL adapters



SAFETY FIRST: Hensley Industries, Inc. recommends that you use a soft-faced hammer **and** ANSI-approved (Z87.1) eye protection while using our products.
Copyright © 2011 Hensley Industries, Inc.

This publication is protected under the copyright laws of the United States. Unauthorized duplication or distribution is prohibited.



250 Series Specifications

Teeth & Fasteners

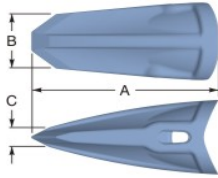

RC
Rock Chisel

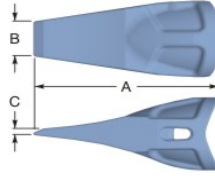

SD
Chisel

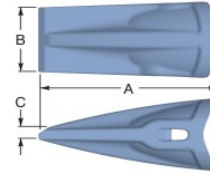

SYL
Sharp, Ribbed

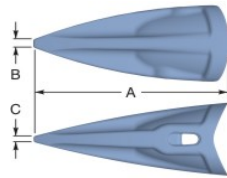

T
Tiger

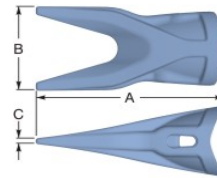

UT
Twin Tiger

TEETH		Dimensions														Weight	
XS Series	Part Number	Pin Assembly	Overall Tooth						Tooth Pocket								
			A		B		C		D		E		F				
			"	mm	"	mm	"	mm	"	mm	"	mm	"	mm	"	mm	lb
250	XS250RC	XS250PX	23.6	600	7.6	192	2.7	68	10.7	273	7.6	192	8.0	202	160.0	72.6	
	XS250SD		22.5	572	5.7	144	2.8	71	10.7	273	7.6	192	8.0	202	161.0	73.0	
	XS250SYL		22.5	571	9.0	228	1.6	41	10.7	273	7.6	192	8.0	202	160.0	72.6	
	XS250T		24.0	609	1.4	35	1.0	25	10.7	273	7.6	192	8.0	202	153.0	69.4	
	XS250UT		24.0	609	11.4	289	-	-	10.7	273	7.6	192	8.0	202	160.0	72.6	

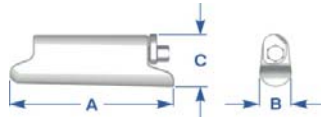

Tooth Pocket

PIN ASSEMBLY		Dimensions						Weight		Socket	
Duty Rating	Part Number	A		B		C					
		"	mm	"	mm	"	mm				
Heavy Duty	XS250PX	10.1	255	2.0	50	3.4	87	10.5	4.8	5/8	16
Standard	XS250PC	10.1	255	2.0	50	3.4	87	10.5	4.8	5/8	16
Slag*	XS250PS	10.1	255	2.0	50	3.4	87	10.5	4.8	5/8	16

* Slag pin is NOT reusable



250 Series Specifications

Weld-on Adapters

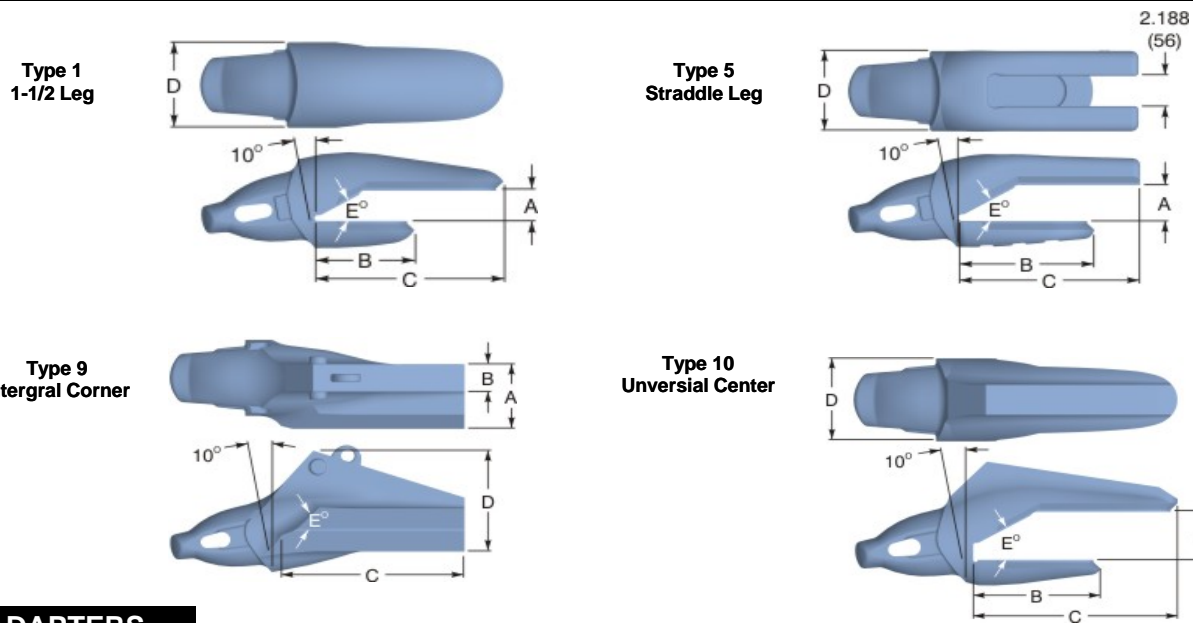

ADAPTERS		Dimensions														Weight	
XS Series	Part Number	Type	A		B		C		D		E	Spade Angle	Lip Thickness				
			"	mm	"	mm	"	mm	"	mm			Bevel	"			mm
250	120XS250SL	5	4.9	124	13.4	339	21.0	533	9.7	246	30°	-	4.75	121	402.0	182.3	
	255XS250*	1	5.7	144	13.5	343	21.7	552	9.8	249	30°	-	5.5	140	280.0	127.0	
	257XS250*	1	4.9	125	13.0	330	21.4	542	9.8	249	30°	-	4.75	121	305.0	138.3	
	475XS250C	10	4.9	124	3.5	89	20.4	517	13.7	349	30°	-	4.75	121	346.0	156.9	
	550XS250C	10	5.7	144	13.5	343	21.7	551	9.7	246	30°	-	5.5	140	340.0	154.2	
	550XS250CL*	9	8.3	209	3.5	89	21.0	533	12.9	327	30°	-	4.75	121	527.0	239.0	
	550XS250CR*	9	8.3	209	3.5	89	21.0	533	12.9	327	30°	-	4.75	121	527.0	239.0	
		XS250WN	Weld-on Nose			9.0	228	9.7	246							121.0	54.9
		WC250HX	Wear Cap													33.0	15.0
	550WS250**	Shroud													52.0	23.6	

* = Available as assembly with wear cap

** = Lower vertical shroud used with 550XS250CR & CL adapters



SAFETY FIRST: Hensley Industries, Inc. recommends that you use a soft-faced hammer **and** ANSI-approved (Z87.1) eye protection while using our products.
Copyright © 2011 Hensley Industries, Inc.

This publication is protected under the copyright laws of the United States. Unauthorized duplication or distribution is prohibited.



252 Series Specifications

Teeth & Fasteners

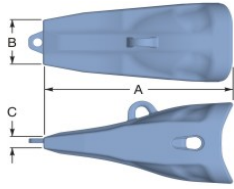

HD
Heavy Duty

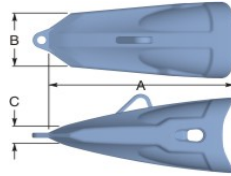

RC
Rock Chisel

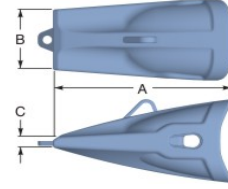

SC
Short Chisel

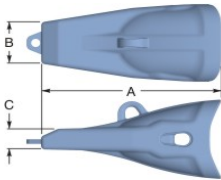

SD
Chisel

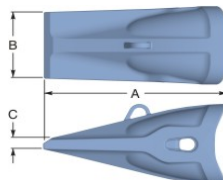

SYL
Sharp, Ribbed

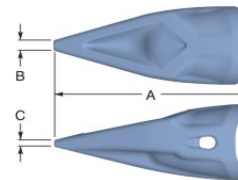

TV
Tiger

TEETH																
XS Series	Part Number	Pin Assembly	Dimensions											Weight		
			Overall Tooth						Tooth Pocket							
			A		B		C		D		E		F	lb	kg	
			"	mm	"	mm	"	mm	"	mm	"	mm	"			mm
252	XS252HD	XS250PX	Under Development													
	XS252RC		23.5	597	7.4	187	2.6	67	10.8	274	7.2	181	8.2	208	213.0	96.6
	XS252SC		21.3	541	7.9	201	1.7	43	10.8	274	7.2	181	8.2	208	177.0	80.3
	XS252SD		22.4	569	5.6	142	2.8	71	10.8	274	7.2	181	8.2	208	193.0	87.5
	XS252SYL		Under Development													
	XS252TV		Under Development													

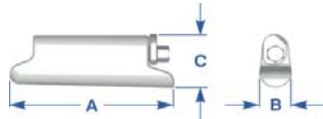

Tooth Pocket

PIN ASSEMBLY											
Duty Rating	Part Number	Dimensions						Weight		Socket	
		A		B		C		lb	kg	"	mm
		"	mm	"	mm	"	mm				
Heavy Duty	XS250PX	10.1	255	2.0	50	3.4	87	10.5	4.8	5/8	16
Standard	XS250PC	10.1	255	2.0	50	3.4	87	10.5	4.8	5/8	16
Slag*	XS250PS	10.1	255	2.0	50	3.4	87	10.5	4.8	5/8	16

* Slag pin is NOT reusable



252 Series Specifications

Weld-on Adapters

Type 1
1-1/2 Leg

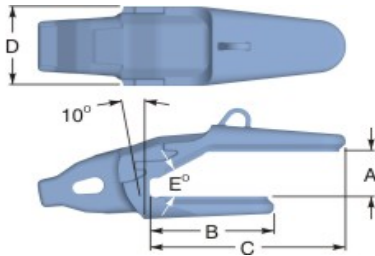

Type 5
Straddle Leg

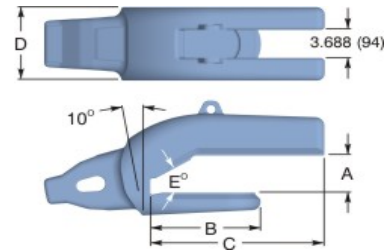

Type 9
Integral Corner

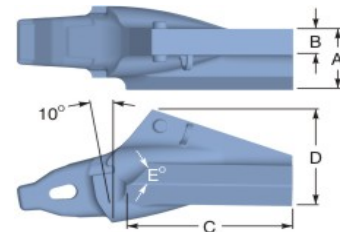

ADAPTERS

XS Series	Part Number	Type	Dimensions											Weight			
			A		B		C		D		E	Spade Angle	Lip Thickness				
			"	mm	"	mm	"	mm	"	mm	Bevel		"	mm	lb	kg	
252	121XS252	1	4.9	123	1.5	38	21.6	549	9.7	246	30°	-	4.75	121	425.0	192.8	
	120XS252SL	5	4.8	123	13.4	342	21.4	546	9.6	246	30°	-	4.75	121	400.0	181.4	
	144XS252	1	5.7	143	14.3	362	22.3	565	9.7	246	30°	-	5.5	140	410.0	186.0	
	255XS252*	1	5.7	143	13.7	348	21.7	551	9.7	246	30°	-	5.5	140	333.0	151.0	
	257XS252*	1	4.9	123	13.2	335	21.2	539	10.0	254	30°	-	4.75	121	353.0	160.1	
	475XS252C		Under Development														
	550XS252C		Under Development														
	550XS252CL*	9	8.3	209	3.5	89	21.0	533	15.5	393	30°	-	4.75	121	573.0	259.9	
	550XS252CR*	9	8.3	209	3.5	89	21.0	533	15.5	393	30°	-	4.75	121	573.0	259.9	
		XS252WN	Weld-on Nose														141.0
	WC252HX	Wear Cap														33.0	15.0
	550WS252**	Shroud														52.0	23.6

* = Available as assembly with wear cap

** = Lower vertical shroud used with 550XS252CR & CL adapters



SAFETY FIRST: Hensley Industries, Inc. recommends that you use a soft-faced hammer **and** ANSI-approved (Z87.1) eye protection while using our products.

Copyright © 2011 Hensley Industries, Inc.

This publication is protected under the copyright laws of the United States. Unauthorized duplication or distribution is prohibited.



340 Series Specifications

Teeth & Fasteners

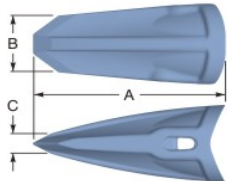

RC
Rock Chisel

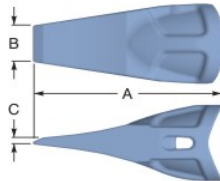

SD
Chisel

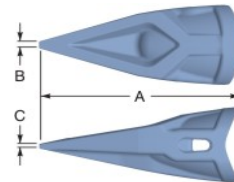

TV
Tiger

TEETH																
XS Series	Part Number	Pin Assembly	Dimensions												Weight	
			Overall Tooth						Tooth Pocket							
			A		B		C		D		E		F		lb	kg
340	XS340RC	XS340PX	24.8	628	8.5	216	2.9	75	11.7	298	7.3	186	9.1	232	226.0	102.5
	XS340SD		23.6	598	6.2	158	2.8	70	11.7	298	7.3	186	9.1	232	222.0	100.7
	XS340TV		25.2	640	1.6	40	1.0	26	11.7	298	7.3	186	9.1	232	219.0	99.3

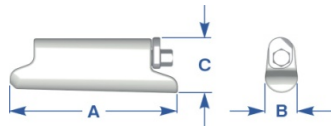

PIN ASSEMBLY												
Duty Rating	Part Number	Dimensions						Weight		Socket		
		A		B		C		lb	kg	"	mm	
		"	mm	"	mm	"	mm					
Heavy Duty	XS340PX	9.6	244	1.8	47	3.5	88	11.0	5.0	5/8	16	
Slag*	XS340PS	9.6	244	1.8	47	3.5	88	11.0	5.0	5/8	16	

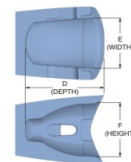

Tooth Pocket

* Slag pin is **NOT** reusable



340 Series Specifications

Weld-on Adapters

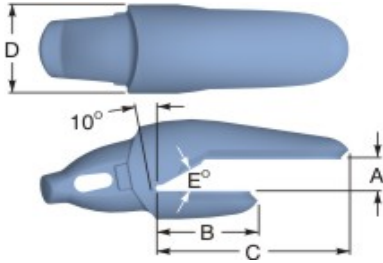

Type 1
1-1/2 Leg

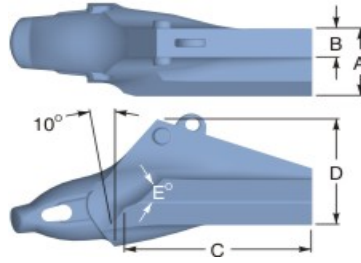

Type 9
Integral Corner

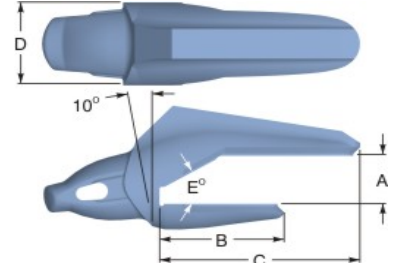

Type 10
Universal Center

ADAPTERS																	
XS Series	Part Number	Type	Dimensions											Weight			
			A		B		C		D		E	Spade Angle	Lip Thickness				
			"	mm	"	mm	"	mm	"	mm	Bevel		"	mm	lb	kg	
340	140XS340*	1	5.7	144	13.4	340	20.3	516	10.5	266	30°	-	5.5	140	341.0	154.7	
	550XS340CL*	9	9.6	244	3.5	89	23.6	599	19.1	486	30°	-	5.5	140	833.0	377.8	
	550XS340CR*	9	9.6	244	3.5	89	23.6	599	19.1	486	30°	-	5.5	140	833.0	377.8	
	550XS340C	10	5.7	144	13.7	347	20.6	524	10.5	266	30°	-	5.5	140	375.0	170.1	
	XS340WN	Weld-on Nose														158.0	71.7
	WC140HX	Wear Cap														40.0	18.1
550WS340**	Shroud														57.0	25.9	

* = Available as assembly with wear cap

** = Lower vertical shroud used with 550XS340CR & CL adapters



SAFETY FIRST: Hensley Industries, Inc. recommends that you use a soft-faced hammer and ANSI-approved (Z87.1) eye protection while using our products.

Copyright © 2011 Hensley Industries, Inc.

This publication is protected under the copyright laws of the United States. Unauthorized duplication or distribution is prohibited.



342 Series Specifications

Teeth & Fasteners

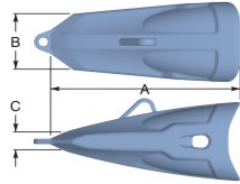

RC
Rock Chisel

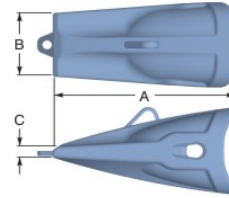

SC
Short Chisel

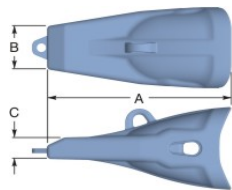

SD
Chisel

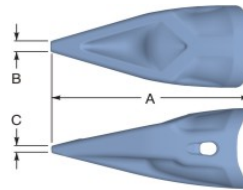

TV
Tiger

TEETH																
XS Series	Part Number	Pin Assembly	Dimensions											Weight		
			Overall Tooth						Tooth Pocket							
			A		B		C		D		E		F	lb	kg	
			"	mm	"	mm	"	mm	"	mm	"	mm	"			mm
342	XS342RC	XS340PX	24.5	621	8.5	215	2.8	71	11.5	291	6.8	173	8.9	225	230.0	104.3
	XS342SC		22.3	566	7.9	201	1.8	46	11.5	291	6.8	173	8.9	225	209.0	94.8
	XS342SD		23.6	599	6.2	157	3.1	79	11.5	291	6.8	173	8.9	225	231.0	104.8
	XS342TV		Under Development													

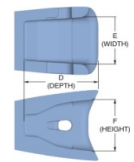
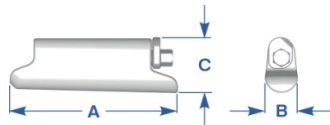

PIN ASSEMBLY											
Duty Rating	Part Number	Dimensions						Weight		Socket	
		A		B		C		lb	kg	"	mm
		"	mm	"	mm	"	mm				
Heavy Duty	XS340PX	9.6	244	1.8	47	3.5	88	11.0	5.0	5/8	16
Slag*	XS340PS	9.6	244	1.8	47	3.5	88	11.0	5.0	5/8	16

Tooth Pocket

* Slag pin is NOT reusable



342 Series Specifications

Weld-on Adapters

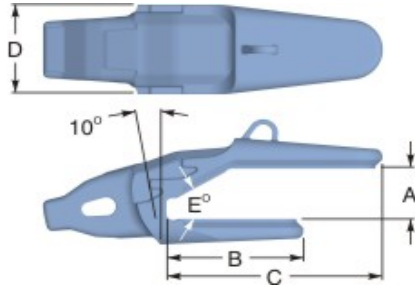

Type 1
1-1/2 Leg

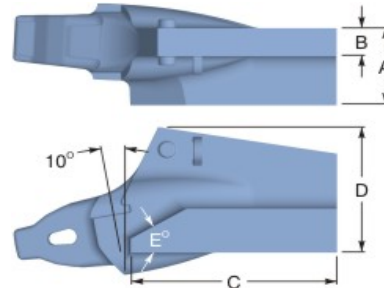

Type 9
Integral Corner

ADAPTERS																	
XS Series	Part Number	Type	Dimensions												Weight		
			A		B		C		D		E	Spade Angle	Lip Thickness				
			"	mm	"	mm	"	mm	"	mm	"		mm	Bevel	"	mm	lb
342	140XS342*	1	5.66	140	14.15	359	22.18	563	9.69	246	30°	-	5.5	140	390	176.9	
	144XS342	1	5.97	144	14.20	362	22.25	565	9.68	246	30°	-	5.5	140	428	194.1	
	550XS342C	10	Under Development														
	550XS342CL*	9	9.62	244	3.50	89	24.00	609	15.72	399	30°	-	5.5	140	825	374.2	
	550XS342CR*	9	9.62	244	3.50	89	23.60	609	19.13	486	30°	-	5.5	140	825	374.2	
	XS342WN	Weld-on Nose														175.0	79.4
	WC342HX	Wear Cap														53.0	24.0
550WS342**	Shroud														61.0	27.7	

* = Available as assembly with wear cap

** = Lower vertical shroud used with 550XS342CR & CL adapters



SAFETY FIRST: Hensley Industries, Inc. recommends that you use a soft-faced hammer **and** ANSI-approved (Z87.1) eye protection while using our products.
Copyright © 2011 Hensley Industries, Inc.

This publication is protected under the copyright laws of the United States. Unauthorized duplication or distribution is prohibited.



TS922 Series Specifications

Teeth & Fasteners

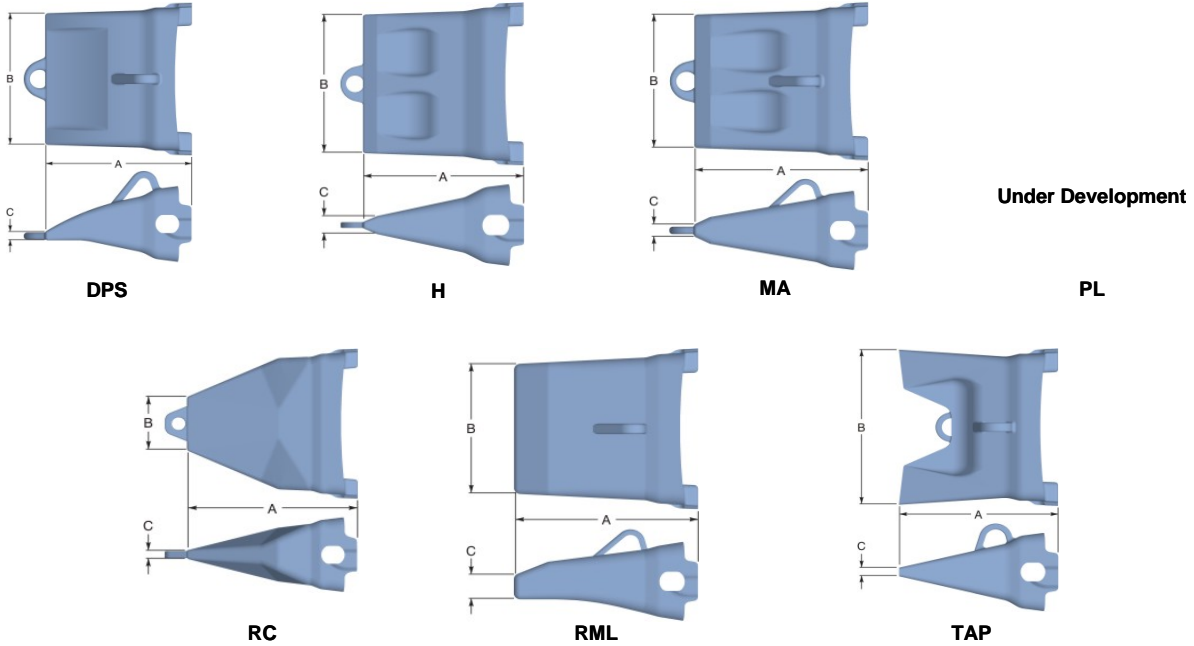

TEETH		Pin Assembly	Dimensions											Weight		
XS Series	Part Number		Overall Tooth						Tooth Pocket							
			A		B		C		D		E		F			
TS922	TS922DPS	TS922P	"	mm	"	mm	"	mm	"	mm	"	mm	"	mm	lb	kg
	TS922H		11.5	292	11.5	292	0.8	19	6.0	152	9.4	239.0	4.1	103.0	93.0	42.2
	TS922MA		Under Development													
	TS922PL		Under Development													
	TS922RC		Under Development													
	TS922RML		14.1	359	10.8	273	2.0	51	6.0	152	9.4	239.0	4.1	103.0	138.0	62.6
	TS922TAP		12.5	317	13.1	333	0.8	19	6.0	152	9.4	239.0	4.1	103.0	84.0	38.1

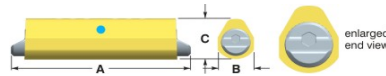

1/2" extension with 3/4" drive

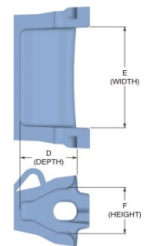

Tooth Pocket

TOOTH PIN ASSEMBLY		Part Number	Dimensions						Weight	
Type	Pin		A		B		C			
			"	mm	"	mm	"	mm	lb	kg
Pin	TS922P	10.8	274	1.9	48	2.3	57	8.7	3.9	
Protective Plug	TS922PL									



TS922 Series Specifications

Adapters

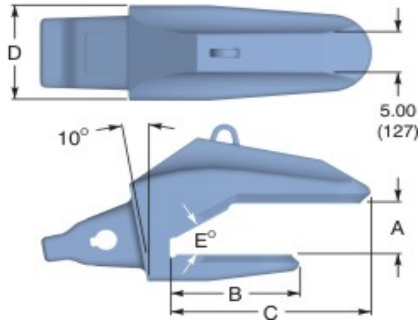

Type 15
Hensley Base - Corner

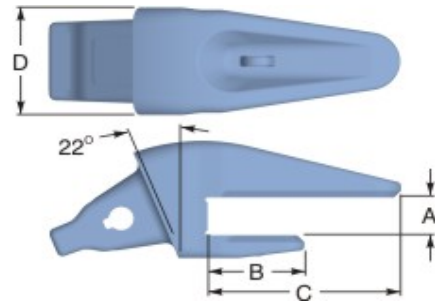

Type 16
Hensley Base - Center

BASE (LIP) ADAPTERS

XS Series	Part Number	Type	Dimensions											Weight		
			A		B		C		D		Down Pitch	Lip Thickness				
			"	mm	"	mm	"	mm	"	mm		"	mm	"	mm	lb
XS390	160XS390*	16	6.5	164	14.7	373	23.0	586	12.0	305	10°			590.0	267.6	
	163XS390C	15	6.5	164	15.3	387	17.9	454	12.0	305	10°	6.3	160	770.0	349.3	
	400XS390**	16	4.2	105	10.0	254			12.0	305	22°	6.3	160	590.0	267.6	
	500XS390**		Under Development													
	630XS390CL*		Under Development													
	630XS390CR*		Under Development													
	XS390WN	Weld-on Nose														
	WC390HX	Wear Cap													86.0	39.0
	625WC390**	Shroud														

* = Available as assembly with wear cap

*** = Lower vertical shroud used with 630XS390CR & CL adapters

** = Dragline adapter



SAFETY FIRST: Hensley Industries, Inc. recommends that you use a soft-faced hammer and ANSI-approved (Z87.1) eye protection while using our products.

Copyright © 2011 Hensley Industries, Inc.

This publication is protected under the copyright laws of the United States. Unauthorized duplication or distribution is prohibited.



TS1122 Series Specifications

Teeth & Fasteners

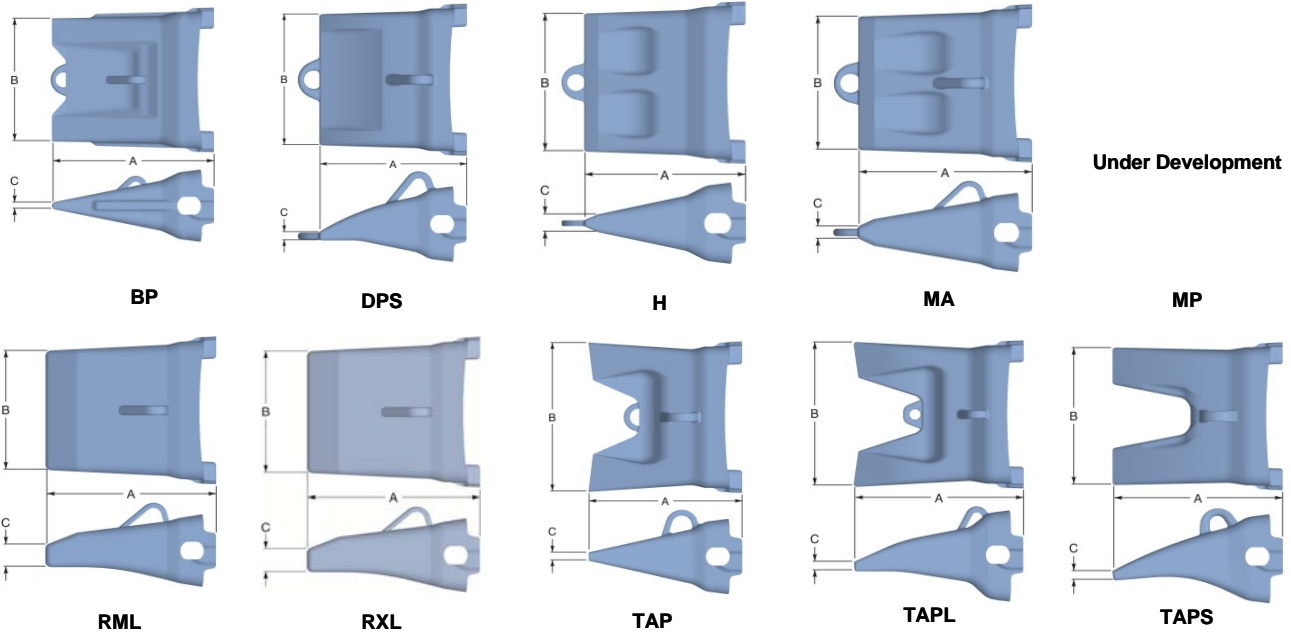

TEETH		Pin Assembly	Dimensions											Weight		
XS Series	Part Number		Overall Tooth						Tooth Pocket							
			A		B		C		D		E		F			
			"	mm	"	mm	"	mm	"	mm	"	mm	"	mm		
TS1122	TS1122BP	TS1122P	16.1	409	13.3	336	0.8	19	7.3	184	11.5	292	5.1	130	150.0	68.0
	TS1122DPS		13.0	330	13.0	330	0.9	22	14.8	376	11.5	292	5.1	130	124.0	56.2
	TS1122H		14.3	362	13.3	336	0.6	16	14.8	376	11.5	292	5.1	130	142.0	64.4
	TS1122MA		15.5	393	15.0	381	1.8	45	14.8	376	11.5	292	5.1	130	217.0	98.4
	TS1122MP		Under Development													
	TS1122RML		14.3	362	12.8	324	2.3	57	14.8	376	11.5	292	5.1	130	185.0	83.9
	TS1122RXL		15.7	398	12.7	322	2.2	56	14.8	376	11.5	292	5.1	130	213.0	96.6
	TS1122TAP		14.7	374	15.2	387	0.8	19	14.8	376	11.5	292	5.1	130	128.0	58.1
	TS1122TAPL		16.7	424	15.3	387	1.0	25	14.8	376	11.5	292	5.1	130	163.5	74.2
	TS1122TAPS		16.7	424	14.5	368	1.0	25	14.8	376	11.5	292	5.1	130	210.0	95.3

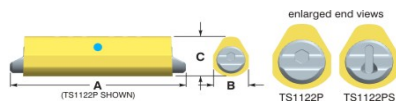

TOOTH PIN ASSEMBLY

Type	Part Number	Dimensions						Weight		Socket	
		A		B		C					
		"	mm	"	mm	"	mm	lb	kg	"	mm
Pin	TS1122P	12.8	324	2.3	59	2.8	70	15.3	6.9	1 1/8	28
Pin	TS1122PS	12.8	324	2.3	59	2.8	70	15.3	6.9	1 1/8	28
Plug	TS1122PL										
Removal Tool	TS1122RT										

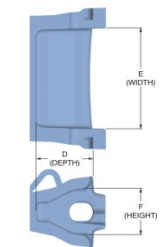

Tooth Pocket



TS1122 Series Specifications

Adapters

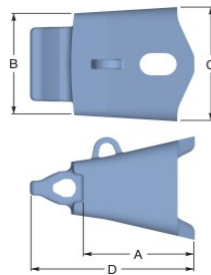

Type 11
Conical Base Style

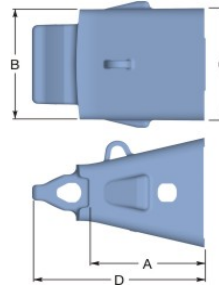

Type 12
S-Series Posilok Base Style

INTERMEDIATE ADAPTERS

XS Series	Part Number	Type	Dimensions												Weight	
			A		B		C		D		E		F			
			"	mm	"	mm	"	mm	"	mm	"	mm	"	mm	lb	kg
TS1122	130TS1122	11	14.3	362	14.4	365	15.8	401	21.5	545	11.9	303	10.2	259	398.0	180.5
	534TS1122NR	12	12.4	314	14.5	368	14.2	360	19.5	496	11.9	303	10.2	259	382.0	173.3
	640TS1122	12	13.0	330	14.5	368	14.8	374	20.2	512	11.9	303	10.2	259	386.0	175.1
	640TS1122NR	12	Under Development												-	-
	A640TS1122*	12	Under Development												-	-
	A640TS122B*	12	Under Development												-	-
	800TS1122NR	12	Under Development												-	-
	XS640WN	Weld-on Nose														

*= Sold with Laminite WB75 welded in place

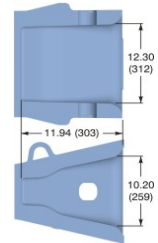
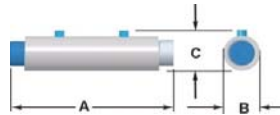

Adapter Pocket

INTERMEDIATE ADAPTER PIN ASSEMBLY

Type	Part Number	Dimensions						Weight	
		A		B		C			
		"	mm	"	mm	"	mm	lb	kg
Pin	XS640TPX	12.9	326	2.7	68	3.1	79	17.0	7.7
Removal Tool	XS640MPR								





TS1222 Series Specifications

Teeth & Fasteners

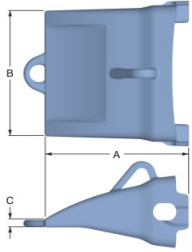

DPS

Under Development

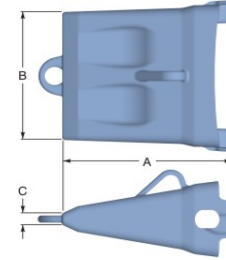

MA

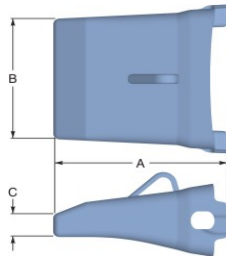

RML

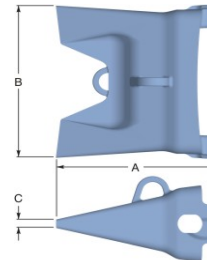

TAP

TEETH

XS Series	Part Number	Pin Assembly	Dimensions											Weight		
			Overall Tooth				Tooth Pocket									
			A		B		C		D		E		F			
			"	mm	"	mm	"	mm	"	mm	"	mm	"	mm	mm	mm
TS1222	TS1222DPS	TS1222P	15.8	403	14.3	361	1.1	28	8.1	206	12.9	327	5.7	146	192.0	87.1
	TS1222KP		Under Development													
	TS1222MA		15.5	393	15.0	381	1.8	45	8.1	206	12.9	327	5.7	146	217.0	98.4
	TS1222RML		16.7	425	15.0	381	4.3	108	8.1	206	12.9	327	5.7	146	280.0	127.0
	TS1222TAP		16.0	406	17.2	438	1.0	25	8.1	206	12.9	327	5.7	146	182.0	82.6

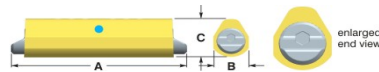

TOOTH PIN ASSEMBLY

Type	Part Number	Dimensions						Weight		Socket	
		A		B		C		lb	kg	"	mm
		"	mm	"	mm	"	mm				
Pin	TS1222P	14.4	366	3.5	89	3.0	76	27.0	12.2	1 1/8	28
Plug	TS1222PL										
Removal Tool	TS1222RT										

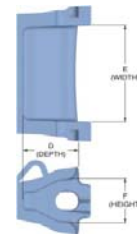

Tooth Pocket



TS1222 Series Specifications

Adapters

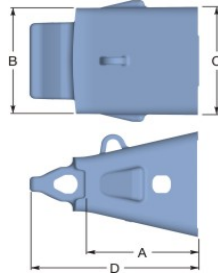

Type 12
S-Series Posilok Base Style

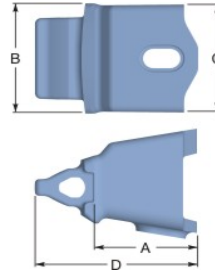

Type 13
Conical Base Style
Non-Rotational

INTERMEDIATE ADAPTERS

XS Series	Part Number	Type	Dimensions												Weight	
			A		B		C		D		E		F		lb	kg
			"	mm	"	mm	"	mm	"	mm	"	mm	"	mm		
TS1222	130TS1222		Under Development													
	574TS1222*	13			16.00	406.1	18.20	461.9	23.70	601.5	13.2	336	14.2	361	595.0	15102
	A574TS1222		Under Development													
	A574TS1222B		Under Development													
	640TS1222	12	13.00	329.9	16.00	406.1	14.75	374.4	21.07	534.8	13.2	336	14.2	361	515.0	233.6
	800TS1222	12	13.30	337	15.90	405	16.20	412	22.40	567	13.2	336	14.2	361	560.0	254.0
	XS800WN	Weld-on Nose														

* = Sold with Laminite (WB75) welded in place

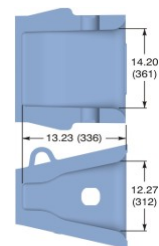
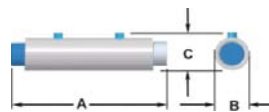

Adapter Pocket

INTERMEDIATE ADAPTER PIN ASSEMBLY

Type	Part Number	Dimensions						Weight	
		A		B		C		lb	kg
		"	mm	"	mm	"	mm		
Pin	XS800TPX	14.70	373.1	3.00	76.14	3.60	91.37	35.0	15.88
Removal Tool	XS640MPR								



SAFETY FIRST: Hensley Industries, Inc. recommends that you use a soft-faced hammer **and** ANSI-approved (Z87.1) eye protection while using our products.
Copyright © 2011 Hensley Industries, Inc.

This publication is protected under the copyright laws of the United States. Unauthorized duplication or distribution is prohibited.



XSC12 Series Specifications

Adapters

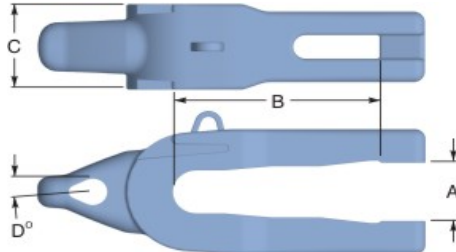

Whisler with Wear Cap

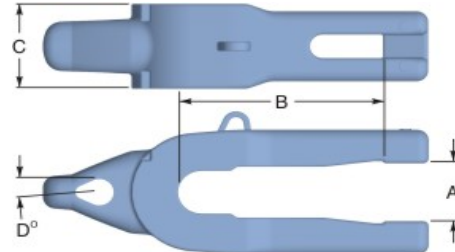

Whisler without Wear Cap

ADAPTERS													
XS Series	Part Number	Type	Dimensions									Weight	
			A		B		C		D	Wear Cap	Fastener Group Number	lb	kg
			"	mm	"	mm	"	mm	Down Pitch				
XSC12	468XSC12	WH-8	5.3	133	20.3	514	8.8	222	0°		1,2	515.0	233.6
	491XSC12	WH-10	6.8	171	22.1	562	10.0	254	0°	WCXSC12	3,4,5,6	669.0	303.5
	492XSC12	WH-10	6.8	171	22.1	562	10.0	254	5°	WCXSC12	3,4,5,6	680.0	308.4
	493XSC12	WH-10	6.8	171	22.1	562	10.0	254	5°		3,4,5,6	684.0	310.3
	498XSC12	WH-10	6.8	171	22.1	562	10.0	254	0°		3,4,5,6	680.0	308.4
	591XSC12	WH-12	6.8	171	23.9	607	10.0	254	0°	WCXSC12	3,7,8,9	690.0	313.0
	592XSC12	WH-12	6.8	171	23.9	607	10.0	254	0°	WCXSC12	3,7,8,9	682.0	309.4
	593XSC12	WH-12	6.8	171	23.9	607	10.0	254	5°		3,7,8,9	706.0	320.2
	598XSC12	WH-12	6.8	171	23.9	607	10.0	254	0°		3,7,8,9	714.0	323.9
	4530XSC12	Berkely	4.6	117	23.7	602	10.0	254	0°		6	745.0	337.9
	5109XSC12	Berkely	6.4	162	23.5	597	11.7	298	0°	WCXSC12	10	762.0	345.6
	5521XSC12	Berkely	4.9	125	21.0	533	10.0	254	0°		6	767.0	347.9
	5608XSC12	Berkely	6.4	162	23.5	597	11.8	298	5°		10	790.0	358.3
	5609XSC12	Berkely	6.4	162	23.5	597	11.8	298	5°	WCXSC12	10	780.0	353.8
	WCXSC12	Wear Cap										49.0	22.2

* = Reverse stabilizer



XSC12 Series Specifications

Fasteners

Fastener					
XS Series	Group Number	Part Number	Type	Style	Hammerless
XSC12	1	469C	WH-8	Fluted	No
		469W1 (Std)			
		469W2 (O/S)			
		469W3 (O/S)			
	2	R469C	WH-8	Ratchet	No
		R469EL			
	3	E499C	WH-10	Fluted	No
		E499W1 (Std)			
		E499W2 (O/S)			
		E499W3 (O/S)			
	4	R499C	WH-10	Ratchet	No
		R499EL			
	5	CR499C	WH-10	3 - Piece	No
		CR499W1 (Std)			
		CR499W2 (O/S)			
		CR499SHIM			
	6	H499CR	WH-10	HLCC	Yes
		H499WR (Std)			
		H599WR (O/S)			
		H499SHIM			
	7	R599EL	WH-12	Ratchet	No
		R599EL			
	8	CR599C	WH-12	3-Piece	No
		CR499W1 (Std)			
		CR499W2 (O/S)			
		CR599SHIM			
	9	H599CR	WH-12	HLCC	Yes
		H599WR (Std)			
		H599W2R (O/S)			
		H599SHIM			
10	H5608CR	WH-10	HLCC	Yes	
	H499WR (Std)				
	H599WR (O/S)				
	H499SHIM				

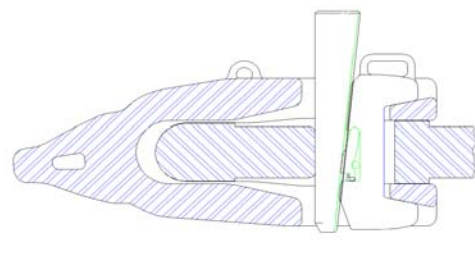

Group 2, 4, 7

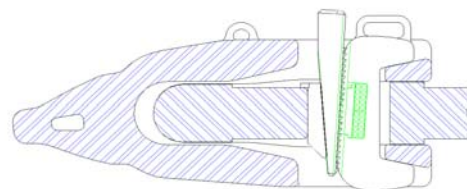

Group 5, 8

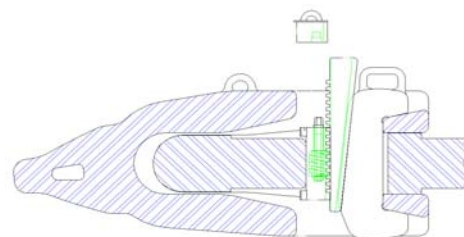

Group 6, 9, 10



SAFETY FIRST: Hensley Industries, Inc. recommends that you use a soft-faced hammer **and** ANSI-approved (Z87.1) eye protection while using our products.
Copyright © 2011 Hensley Industries, Inc.

This publication is protected under the copyright laws of the United States. Unauthorized duplication or distribution is prohibited.



XSC127 Series Specifications

Teeth & Fasteners

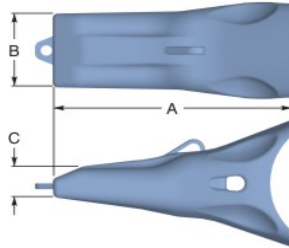

RM

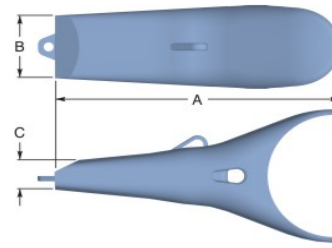

RMHL

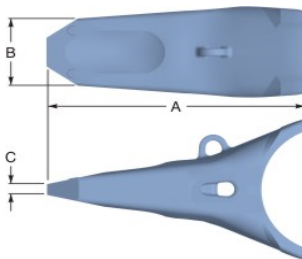

TS

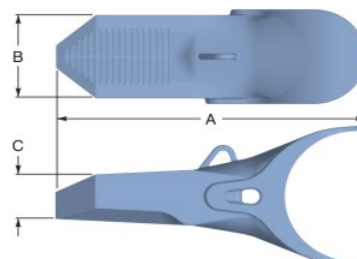

V

TEETH																
XS Series	Part Number	Pin Assembly	Dimensions											Weight		
			Overall Tooth						Tooth Pocket							
			A		B		C		D		E		F	lb	kg	
			"	mm	"	mm	"	mm	"	mm	"	mm	"			mm
XSC127	XSC127RM	XS340PX	21.5	546	8.0	203	3.0	76	11.6	295	-	-	6.5	165	238.0	108.0
	XSC127RMHL		25.1	637	7.5	190	3.3	82	11.6	295	-	-	6.5	165	252.0	114.3
	XSCW127V		31.2	791	9.3	235	3.0	76	11.6	295	-	-	6.5	165	295.0	133.8
	XSC127TS		27.2	689	7.8	198	1.3	32	11.6	295	-	-	10.4	263	262.0	118.8

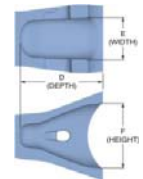
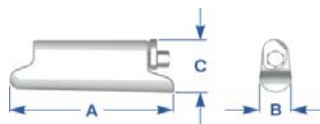

Tooth Pocket

PIN ASSEMBLY											
Duty Rating	Part Number	Dimensions						Weight		Socket	
		A		B		C		lb	kg	"	mm
		"	mm	"	mm	"	mm				
Heavy Duty	XS340PX	9.6	244	1.8	47	3.5	88	11.0	5.0	5/8	16
Slag*	XS340PS	9.6	244	1.8	47	3.5	88	11.0	5.0	5/8	16

* Slag pin is NOT reusable



XSC127 Series Specifications

Adapters

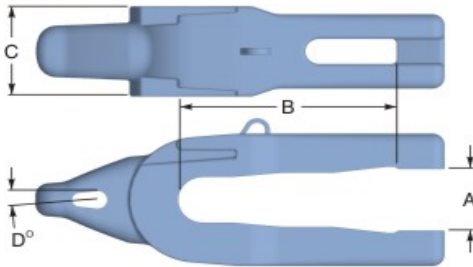

Whisler with Wear Cap

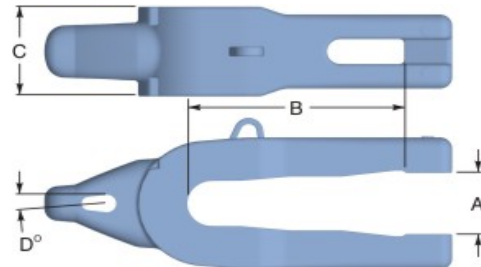

Whisler without Wear Cap

ADAPTERS													
XS Series	Part Number	Type	Dimensions								Weight		
			A		B		C		D	Wear Cap	Fastener Group Number	lb	kg
			"	mm	"	mm	"	mm	Down Pitch				
XSC127	468XSC127	WH-8	5.25	133.2	24.00	609.1	8.75	222.1	0°		1,2	530.0	240.4
	491XSC127	WH-10	6.75	171.3	22.13	561.5	10.00	253.8	0°	WCSXC12	3,4,5,6	677.0	307.1
	492XSC127	WH-10	6.75	171.3	22.13	561.5	10.00	253.8	5°	WCSXC12	3,4,5,6	675.0	306.2
	493XSC127	WH-10	-	-	-	-	-	-	5°		3,4,5,6	-	-
	498XSC127	WH-10	6.75	171.3	22.13	561.5	10.00	253.8	0°		3,4,5,6	693.0	314.3
	5608XSC127	Berkely	6.38	161.8	23.50	596.4	11.75	298.2	5°		10	790.0	358.3
	591XSC127	WH-12	6.75	171.3	23.92	607.2	10.00	253.8	0°	WCSXC12	3,7,8,9	690.0	313.0
	592XSC127	WH-12	6.75	171.3	23.92	607.1	10.00	253.8	5°	WCSXC12	3,7,8,9	700.0	317.5
	593XSC127	WH-12	6.80	173.0	23.80	606.0	10.00	254.0	5°		3,7,8,9	706.0	320.2
	594XSC127*	WH-12	8.81	173.0	23.88	606.0	10.00	254.0	0°	WCSXC12	3,7,8,9	735.0	333.4
	597XSC127	WH-12							5°	WCSXC12	3,7,8,9	693.0	314.3
	598XSC127	WH-12	6.75	171.3	23.92	607.1	10.00	253.8	0°		3,7,8,9	714.0	323.9
	600XSC127	5230 Hyd. Adpt	6.10	156.0	23.70	602.0	10.00	254.0	10°		3,7,8,9	535.0	242.7
		WCXSC12	Wear Cap										49.0

* = Reverse stabilizer



XSC127 Series Specifications

Fasteners

Fastener					
XS Series	Group Number	Part Number	Type	Style	Hammerless
XSC127	1	469C	WH-8	Fluted	No
		469W1 (Std)			
		469W2 (O/S)			
		469W3 (O/S)			
	2	R469C	WH-8	Ratchet	No
		R469EL			
	3	E499C	WH-10	Fluted	No
		E499W1 (Std)			
		E499W2 (O/S)			
		E499W3 (O/S)			
		E499W4 (O/S)			
	4	R499C	WH-10	Ratchet	No
		R499EL			
	5	CR499C	WH-10	3 - Piece	No
		CR499W1 (Std)			
		CR499W2 (O/S)			
		CR499SHIM			
	6	H499CR	WH-10	HLCC	Yes
		H499WR (Std)			
		H599WR (O/S)			
		H499SHIM			
	7	R599EL	WH-12	Ratchet	No
		R599EL			
	8	CR599C	WH-12	3-Piece	No
		CR499W1 (Std)			
		CR499W2 (O/S)			
	9	H599CR	WH-12	HLCC	Yes
		H599WR (Std)			
		H599W2R (O/S)			
		H599SHIM			
10	H5608CR	WH-10	HLCC	Yes	
	H499WR (Std)				
	H599WR (O/S)				
	H499SHIM				

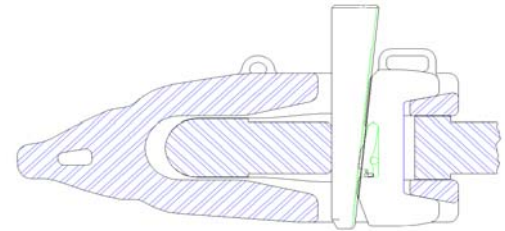

Group 2, 4, 7

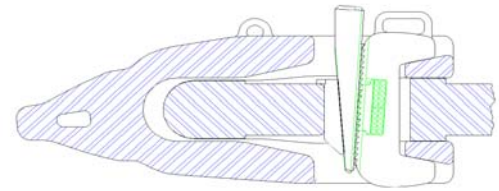

Group 5, 8

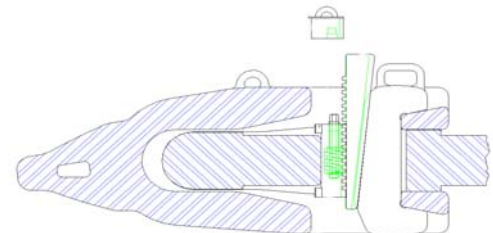

Group 6, 9, 10



SAFETY FIRST: Hensley Industries, Inc. recommends that you use a soft-faced hammer **and** ANSI-approved (Z87.1) eye protection while using our products.
Copyright © 2011 Hensley Industries, Inc.

This publication is protected under the copyright laws of the United States. Unauthorized duplication or distribution is prohibited.