

Cat® 966 & 980G Top Covers for Half-Arrow Edges

NEW

CAST CENTER TOP PLATES

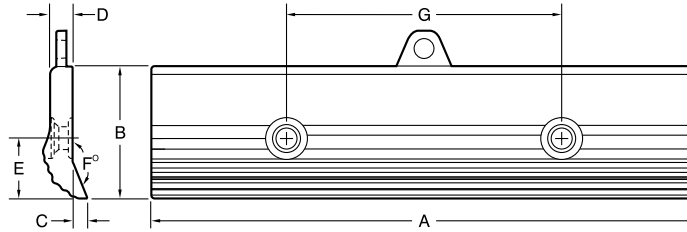

PART NUMBER	DIMENSIONS - Inches (mm)							WEIGHT	
	A	B	C	D	E	F°	G	LBS.	KGS.
980GTPCHX	37-7/8 (962)	8-1/2 (216)	1 (25)	1-3/8 (35)	3-29/32 (99)	22°	19-1/16 (484)	120.0	54.5
966TPCHX	33-17/32 (851)	8-1/8 (206)	15/16 (23)	1-3/8 (35)	3-23/32 (94)	22°	16-7/8 (428)	101.0	45.8
LOADER MODEL	BUCKET WIDTH inches (MM)	TOP PLATE PART NUMBER	NUMBER OF TOP PLATES REQUIRED	USED WITH SEGMENTS		PLOW BOLT ASSEMBLY* (no. req'd.)			
980G	134 (3406)	980GTPCHX	2	1099202NRHX (CTR) 1U0761NRHX (END)		A114-512 (2)			
966	119-1/2 (3035)	966TPCHX	2	1U0593NRHX (CTR) 3G6395RNRHX (RH) 3G6395LNRHX (LH)		A114-412 (2)			

CAST END TOP PLATES

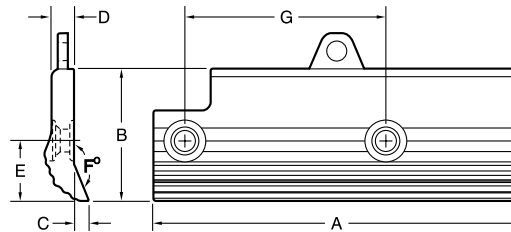

PART NUMBER	DIMENSIONS - Inches (mm)							WEIGHT	
	A	B	C	D	E	F°	G	LBS.	KGS.
980GTPRHX 980GTPLHX	24-1/2 (622)	8-1/2 (216)	1 (25)	1-3/8 (35)	3-29/32 (99)	22°	13-5/32 (334)	73.0	33.1
966TPRHX 966TPLHX	22-1/2 (571)	8-1/8 (206)	15/16 (23)	1-3/8 (35)	3-23/32 (94)	22°	12-1/4 (311)	64.0	29.0
LOADER MODEL	BUCKET WIDTH inches (MM)	TOP PLATE PART NUMBER	NUMBER OF TOP PLATES REQUIRED	USED WITH SEGMENTS		PLOW BOLT ASSEMBLY* (no. req'd.)			
980G	134 (3406)	980GTPRHX 980GTPLHX	1 1	1099202NRHX (CTR) 1U0761NRHX (END)		A114-512 (2)			
966	119-1/2 (3035)	966TPRHX 966GTPLHX	1 1	1U0593NRHX (CTR) 3G6395RNRHX (RH) 1U0593NRHX (CTR) 3G6395LNRHX (LH)		A114-412 (2)			

Hensley Customer Service

Toll Free US / Canada
Phone: (888) 406-6262
Fax: (888) 241-3274

All Other Locations
Phone: (972) 406-6262
Fax: (972) 241-3274

Cat® & Caterpillar® are registered trademarks of Caterpillar, Inc.

www.hensleyind.com

Safety first: Hensley Industries recommends that you use a soft-face hammer and ANSI-approved (Z87.1) eye protection when using our products.

© 2010 Hensley Industries, Inc.

Access to any specific item is subject to your individual dealer classification.