

# BLADESAVER QM™

## LOADER LIP SYSTEM



BREAKTHROUGH



# Bladesaver QM™ Loader Lip System

The new Hensley Bladesaver QM™ loader lip system is engineered and manufactured by Hensley for the quarry and mining markets.

- Fully integrated lip system
- 100% lip protection for reduced wear on base lip
- Fully mechanical wear components
- Streamline profile for easier penetration and loading.

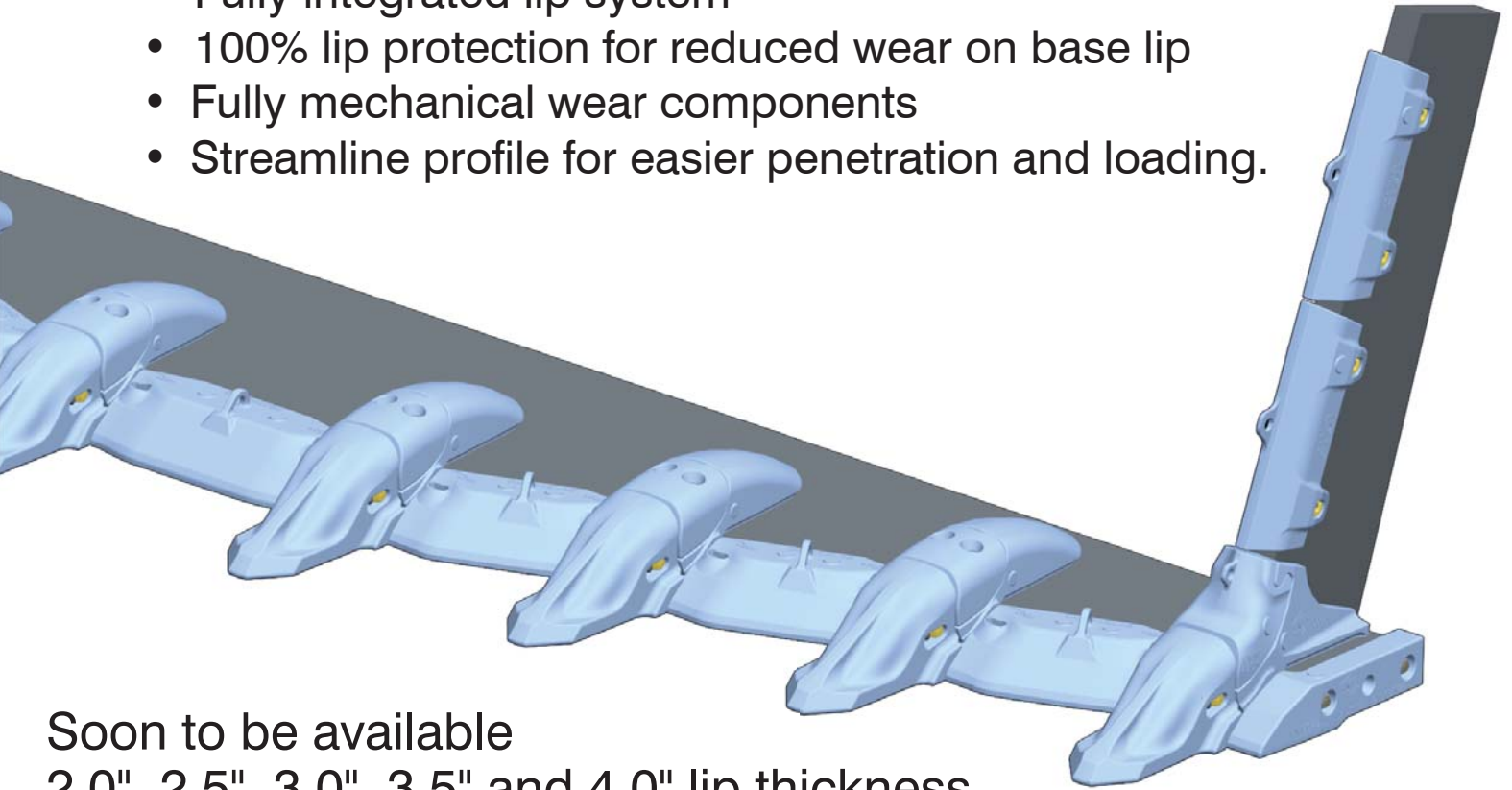

Soon to be available

2.0", 2.5", 3.0", 3.5" and 4.0" lip thickness

Suitable for loaders with breakout forces ranging from 50,000 lbs and greater.





## Smooth bottom of lip edge

- Increases production
- Reduces tire wear

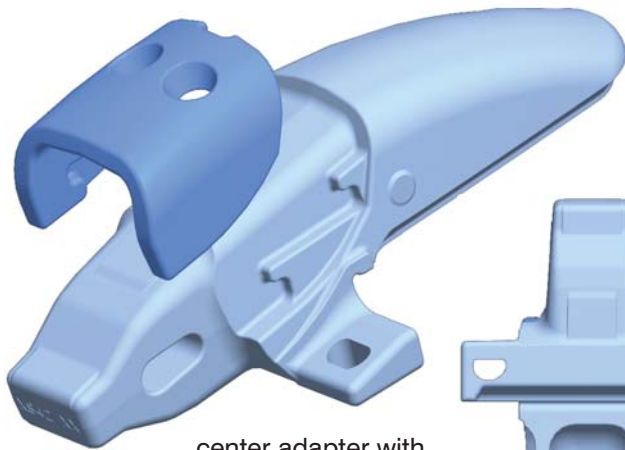
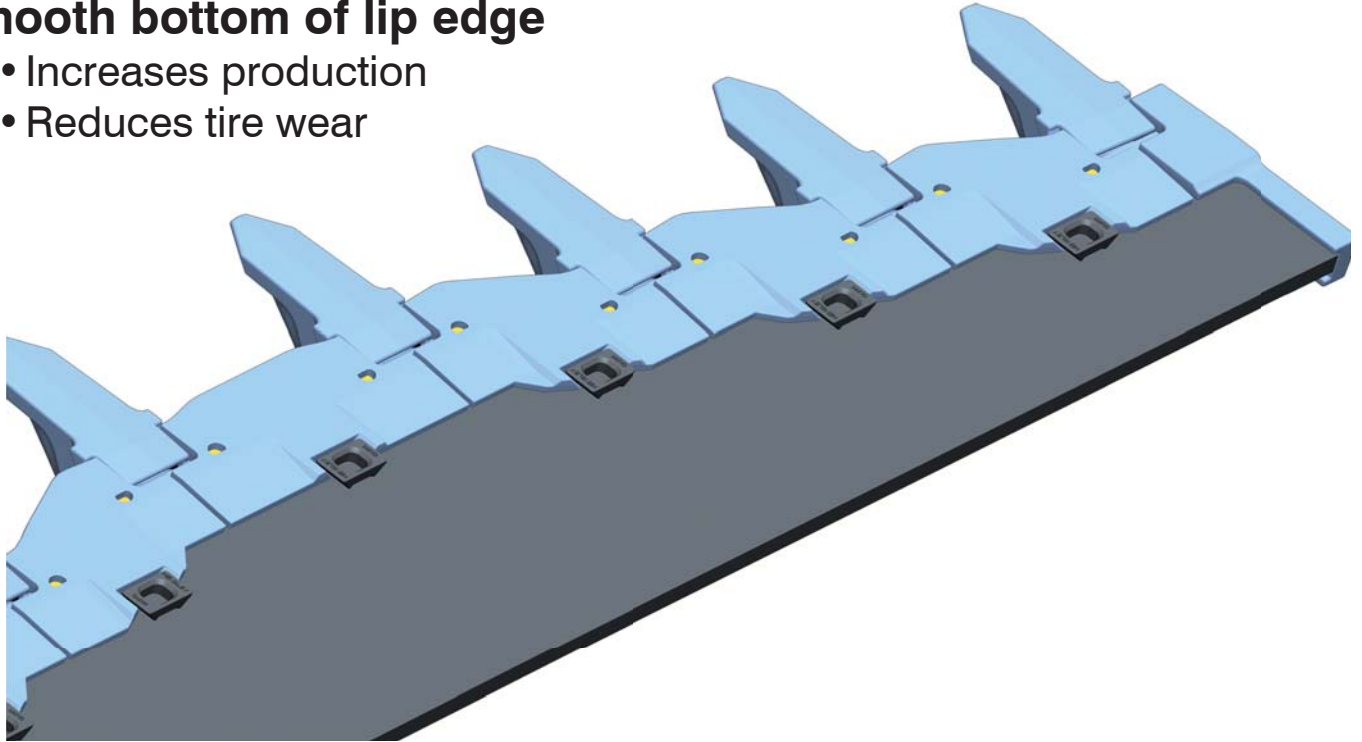

center adapter with  
replaceable wear cap



straddle leg corner adapter  
with replaceable wear cap

## Unique flush style adapters

- Allows greater lip shroud wear consumption
- Greater weld area and strength than standard flush adapters
- Corner adapters add greater strength & wear for bucket corners
- Mechanical wear caps are standard offering

# End Caps and Vertical Shrouds

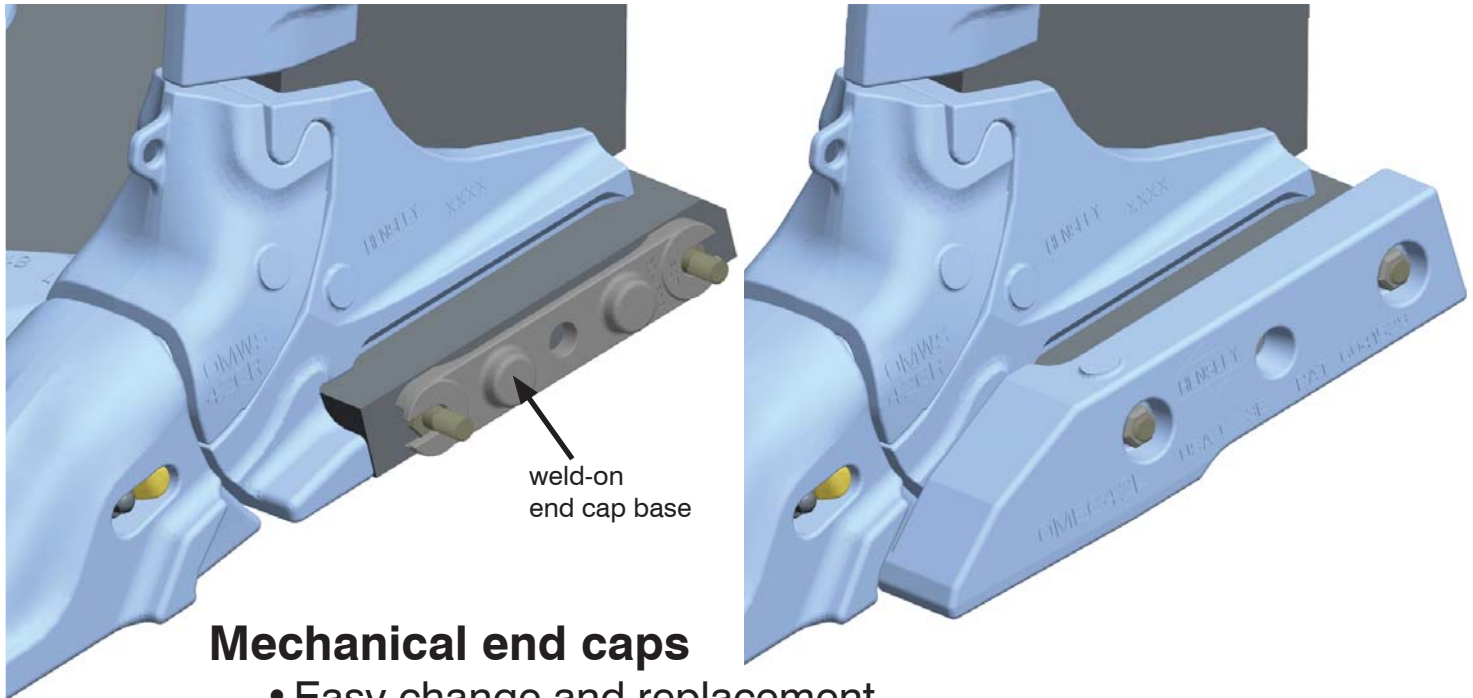

## Mechanical end caps

- Easy change and replacement
- Offer complete protection for outer edges
- Outer edge, front edge and bottom corner are protected with 477-512 BHN cast steel

## Universal vertical shroud

- Mechanically attached with hammerless pin
- One part for standardization and reduction of components
- Shroud can be stacked and rotated for greater wear life utilization

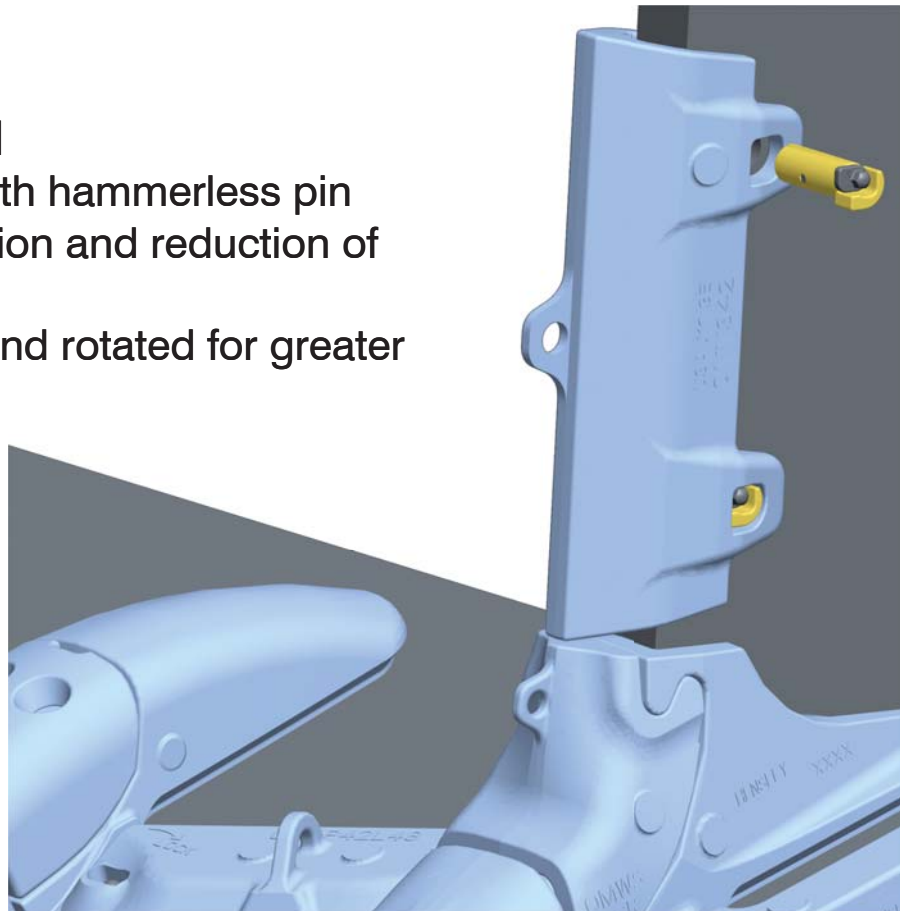

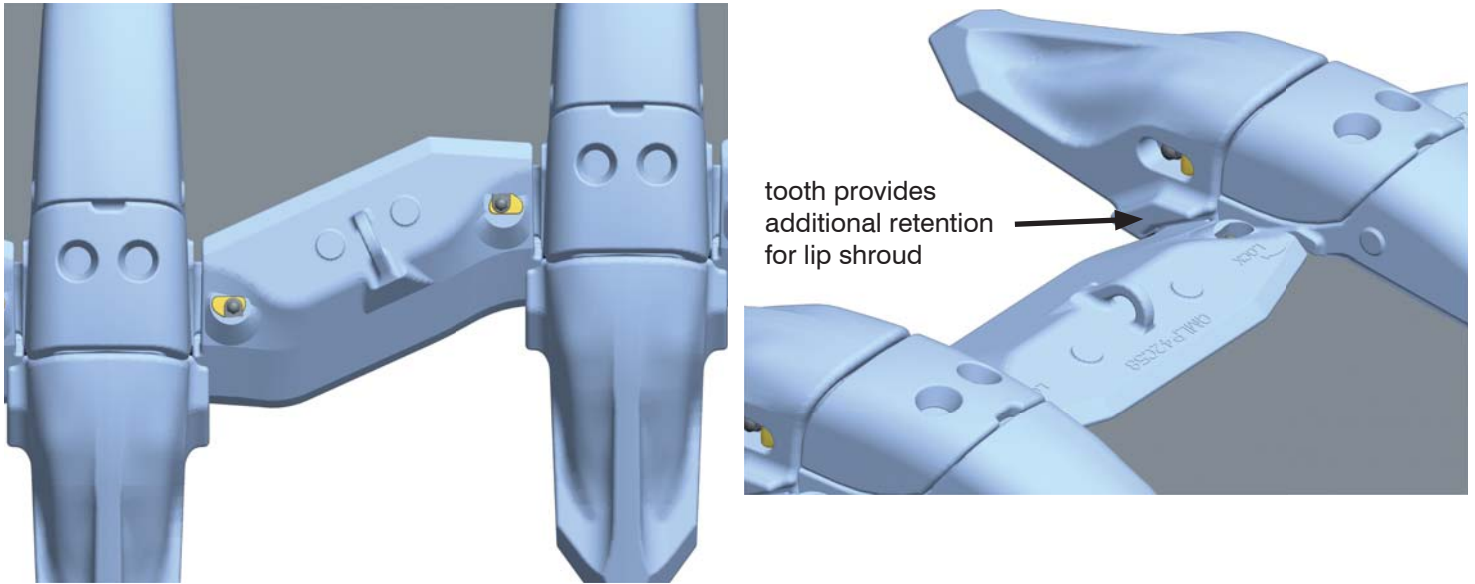

## Lip Shrouds

- FULL LIP COVERAGE with minimal gap between shroud and tooth
- Lip shrouds are 100% mechanical with hammerless fasteners
- Tooth acts as dual retention for lip shroud to prevent loss of parts
- Lip shrouds have been designed for greater wear utilization

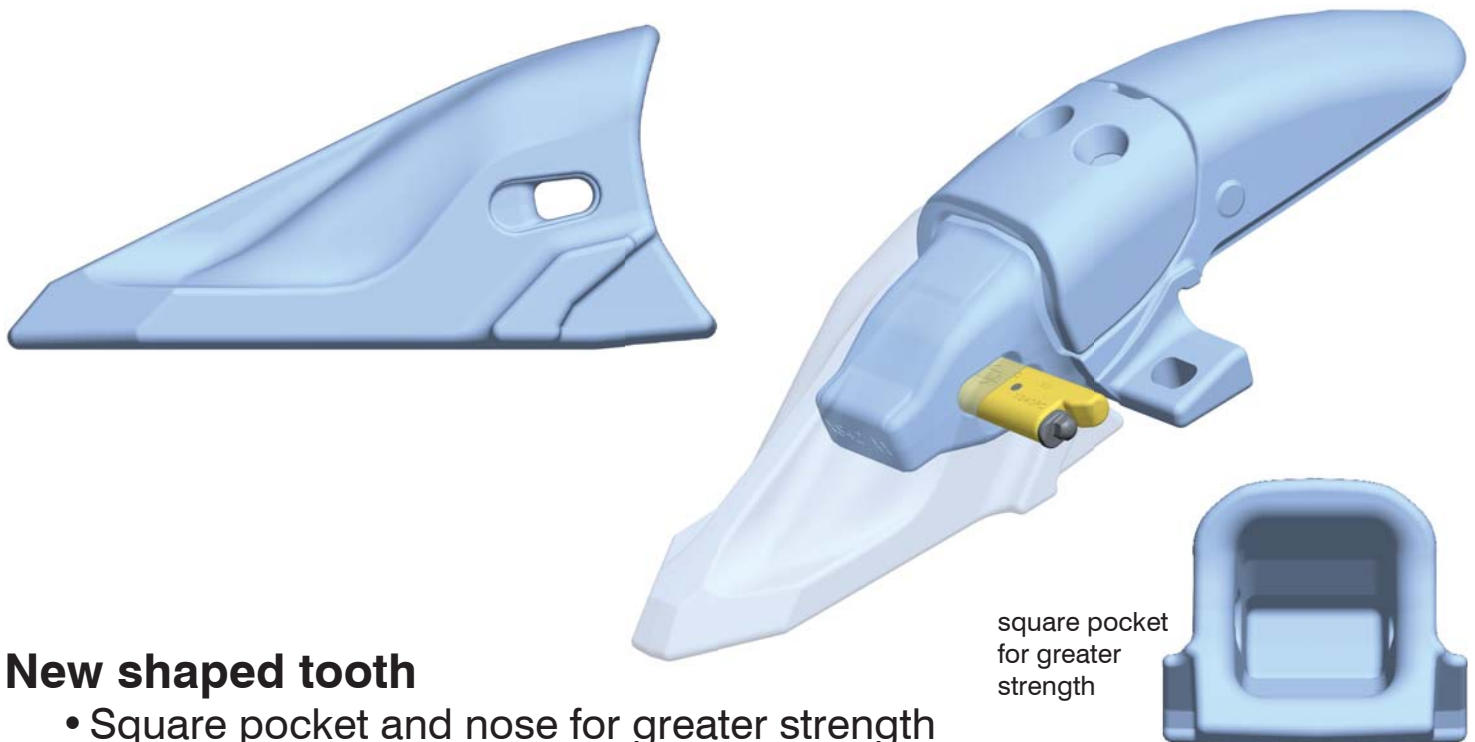

## New shaped tooth

- Square pocket and nose for greater strength
- Hammerless pin for safe, quick and easy change out
- Due to quick tooth change out, teeth can be rotated easily for even wear across the lip positions resulting in higher wear utilization



# Application









Hensley Industries, Inc. has been manufacturing and marketing ground engaging tools, buckets and specialized attachments since 1947. We are committed to providing the best service and highest quality products in the world. Our dedication to excellence allows us to help those who use it in the field every day.

## **HENSLEY INDUSTRIES, INC.**

2108 Joe Field Road  
Dallas, Texas 75229, USA

### **CUSTOMER SERVICE**

#### **G.E.T & CUTTING EDGES**

USA/CANADA - (888) 406-6262  
ALL OTHER LOCATIONS - +1 (972) 406-6262

#### **BUCKETS & ATTACHMENTS**

USA/CANADA - (800) 433-3144  
ALL OTHER LOCATIONS - +1 (817) 477-3167

**WWW.HENSLEYIND.COM**



Safety First! Hensley Industries recommends that you use appropriate personal protective equipment and follow proper safety procedures when using our products.