

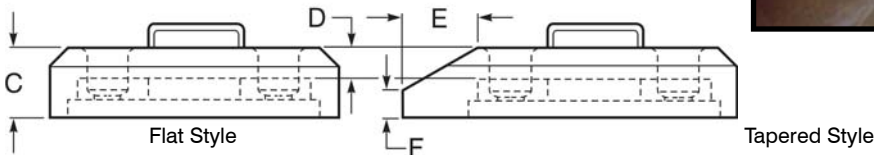

BOLT-ON WEAR RUNNERS and BASES

- SPECIFICS:**
- High-wear area protection
 - Extends equipment life
 - Bolt-on design
 - Fast and easy change-outs
 - Position end to end & side to side

Hensley Wear Runners are designed for high-wear areas on all your earth-moving / earth-hauling equipment, reducing down time during change-outs and to allow being positioned end to end and side to side. After initial installation of the wear runner weld-on base, change-outs are fast and easy with Hensley's bolt-on design. For speed and ease in change-outs and extended life for all your equipment, switch to **Hensley Wear Runners** today.

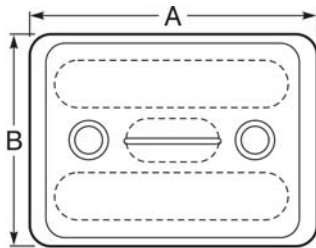
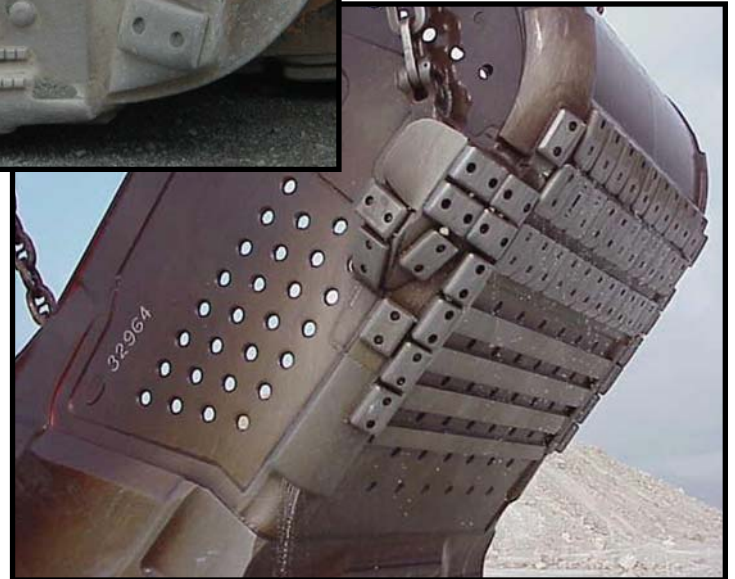

WEAR RUNNERS

| WEAR RUNNERS | STYLE | DIMENSIONS - INCHES (MM) | | | | | | WEIGHT lbs. / kgs. | BASE | FASTENER | SOCKET SIZE |
|-----------------------------|---------|--------------------------|----------|------------|------------|------------|-----------|-----------------------|--------|------------|----------------|
| | | A | B | C | D | E | F | | | | |
| B8X8WR175 | Flat | 8 (203) | 8 (203) | 1.75 (44) | .75 (19) | N/A | N/A | 20.0 / 9.1 | 8X8B | 58125BCRNF | 15/16 (24) |
| B10X7WRS | Flat | 10 (254) | 7 (178) | 2.94 (75) | 1.25 (32) | N/A | N/A | 35.5 / 16.1 | 10X7B | 115BLN | 1.5 (38) |
| B10X8WR175 | Flat | 10 (254) | 8 (203) | 1.75 (44) | .75 (19) | N/A | N/A | 25.5 / 11.6 | 10X8B | 58125BCRNF | 15/16 (24) |
| B10X10WR275 | Flat | 10 (254) | 10 (254) | 2.75 (70) | 1 (25) | N/A | N/A | 40.0 / 18.1 | 10X10B | 115BLN | 1.5 (38) |
| B10X10WR5 | Flat | 10 (254) | 10 (254) | 5 (127) | 3 (76) | N/A | N/A | 100.0 / 45.4 | 10X10B | 115BLN | 1.5 (38) |
| B12X9WR | Flat | 12 (305) | 9 (229) | 3 (76) | 1.25 (32) | N/A | N/A | 49.0 / 22.2 | 12X9B | 115BLN | 1.5 (38) |
| B12X9WR4 | Flat | 12 (305) | 9 (229) | 4 (102) | 2.25 (57) | N/A | N/A | 73.0 / 33.1 | 12X9B | 115BLN | 1.5 (38) |
| B12X12WR | Flat | 12 (305) | 12 (305) | 2.94 (75) | 1.125 (29) | N/A | N/A | 71.8 / 32.6 | 12X12B | 115BLN | 1.5 (38) |
| B14X9WR275T | Tapered | 14 (356) | 9 (229) | 2.75 (70) | 1 (25) | 3 (76) | 1.25 (32) | 52.5 / 23.8 | 12X9B | 115BLN | 1.5 (38) |
| B14X9WR4T | Tapered | 14 (356) | 9 (229) | 3.94 (100) | 1.94 (49) | 2.75 (70) | 1.25 (32) | 94.3 / 42.8 | 12X9B | 115BLN | 1.5 (38) |
| B14X10WR275T | Tapered | 14 (356) | 10 (254) | 2.75 (70) | 1 (25) | 3 (76) | 1.25 (32) | 58.0 / 26.3 | 12X10B | 115BLN | 1.5 (38) |
| B14X10WR4T | Tapered | 14 (356) | 10 (254) | 3.94 (100) | 1.94 (49) | 2.75 (70) | 1.25 (32) | 97.8 / 44.4 | 12X10B | 115BLN | 1.5 (38) |
| B16X10WR3T | Tapered | 16 (406) | 10 (254) | 2.94 (75) | .5 (13) | 4.75 (121) | .75 (19) | 74.5 / 33.8 | 12X10B | 115BLN | 1.5 (38) |
| AB16X10WR3T w / laminite | Tapered | 16 (406) | 10 (254) | 2.94 (75) | .5 (13) | 4.75 (121) | .75 (19) | 74.5 / 33.8 | 12X10B | 115BLN | 1.5 (38) |

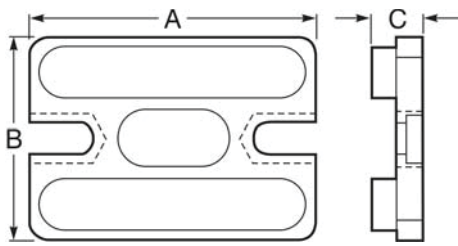

| BASES | | | | | |
|--------|--------------------------|-------------|----------|-----------------------|---|
| BASE | DIMENSIONS - INCHES (MM) | | | WEIGHT lbs. / kgs. | WEAR RUNNER |
| | A | B | C | | |
| 8X8B | 6.9 (174) | 6.9 (174) | .91 (23) | 7.0 / 3.2 | B8X8WR175 |
| 10X7B | 8.37 (213) | 5.37 (136) | 1.8 (46) | 11.0 / 5.0 | B10X7WRS |
| 10X8B | 8.9 (225) | 6.9 (175) | .91 (23) | 9.7 / 4.4 | B10X8WR175 |
| 10X10B | 8.37 (213) | 8.37 (213) | 1.8 (46) | 24.0 / 10.9 | B10X10WR275 / B10X10WR5 |
| 12X9B | 10.38 (263) | 4.75 (121) | 1.8 (46) | 22.0 / 10.0 | B12X9WR / B12X9WR4 B14X9WE275T / B14X9WR47 |
| 12X10B | 10.38 (263) | 8.37 (213) | 1.8 (46) | 28.0 / 12.7 | B14X10WR275T / B14X10WR4T B16X10WR3T / AB16X10WR3T |
| 12X12B | 10.38 (263) | 10.38 (263) | 1.8 (46) | 36.0 / 16.3 | B12X12WR |



Hensley Industries, Inc.
 2108 Joe Field Road • Dallas, TX 75229
Customer Service
 Toll Free U.S./Canada (888) 406-6262
 All other Locations (972) 406-6262
Hensley Attachments
 (800) 433-3144 (817) 477-3167
 www.hensleyind.com



YOUR AUTHORIZED HENSLEY DEALER

Copyright © 2011 Hensley Industries, Inc.
 This publication is protected under the copyright laws of the United States.
 Unauthorized duplication or distribution is prohibited.