



SUCCESS STORY

TS1222 RotoMax - PC5500 Conversions

Application: Mining
Mineral: Uranium
Machine: PC5500
Solution: TS1222

HENSLEY PRODUCT OFFERING

- 644TS1222 Adapters
- TS1222MA Teeth
- TS644P RotoMax Pin System

RESULTS

- Reduced GET Cost per Ton
- Exceptional GET Life Cycle Support
- Improved Product Reliability
- Reduced Customer Maintenance

Customer Upgrades Entire PC5500 Fleet to Hensley RotoMax System!

The Rossing Uranium mine in Namibia recently decided to convert its fleet of PC5500 Front Shovels to Hensley systems. After running an extensive performance trial of all the major mining GET suppliers, Rossing concluded that Hensley's TS1222 RotoMax system was the most cost effective and reliable of the bunch.

The extensive GET life cycle support provided to the customer by their Hensley and Komatsu representatives was without equal. The support team worked diligently with Rossing to ensure that their GET systems were optimized to both maximize product life cycles and reduce overall costs. Implementing a discipline of daily inspection and regular GET performance monitoring helped to ensure their success.

Providing mine management with regular updates on the cost per ton performance also proved to be of great value. This cooperation has strengthened the relationship between Rossing and Hensley, and shifted Hensley's role at the mine from a parts supplier to a strategic partner.

TS1222

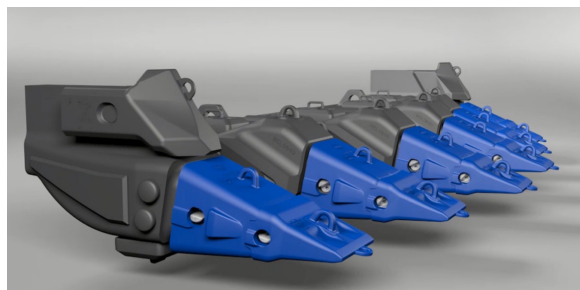

Disclaimer: The opinions and product performance information included in this document were provided by the customer and do not represent or imply a warranty or guarantee of any kind. The performance of Hensley products will vary and be affected by a number of factors that are outside the control of Hensley, include site location, machine make and model, installation procedures, material conditions, operating procedures and conditions, wear and tear, and maintenance practices.

HENSLEY INDUSTRIES, INC.
2108 Joe Field Road
Dallas, Texas 75229, USA
www.hensleyind.com

G.E.T, BUCKETS, & CUTTING EDGES
USA/CANADA – (888) 406-6262
ALL OTHER LOCATIONS – +1 (972) 406-6262

HEC-PC5500-TS1222-0715-01